

# OPERATING MANUAL

## **MASTERflex<sup>®</sup> L/S<sup>®</sup>**

### FIXED FLOW PUMP DRIVES

#### Model Nos.

MFLX07540-01	MFLX07540-30	MFLX07542-12
MFLX07540-02	MFLX07540-60	MFLX07542-20
MFLX07540-06	MFLX07542-01	MFLX07542-30
MFLX07540-12	MFLX07542-02	MFLX07542-60
MFLX07540-20	MFLX07542-06	



Note: Drive is shown with optional Pump Head.

A-1299-1034  
Edition 12

---

**MASTERflex<sup>®</sup>**

(US & Canada only) Toll Free 1-800-MASTERFLEX • 1-800-637-3739  
(Outside US & Canada) 1-847-381-7050

masterflex.tech @ avantorsciences.com | www.avantorsciences.com/masterflex

# **PUMP FOR LIQUIDS ORIGINAL INSTRUCTIONS**

# TABLE OF CONTENTS

Title	Page
SAFETY PRECAUTIONS .....	3
INTRODUCTION AND GENERAL DESCRIPTION .....	4
SETUP AND OPERATION.....	4
MAINTENANCE .....	5
Cleaning .....	6
SPECIFICATIONS.....	6
WARRANTY.....	8
PRODUCT RETURN.....	8
TECHNICAL ASSISTANCE.....	8

## SAFETY PRECAUTIONS

**WARNINGS:** *To reduce risk of electrical shock, connect only to a properly grounded, grounding-type receptacle.*



*Remove power from the drive before attempting any maintenance.*

*Remove power before any cleaning operation is started.*

*Risk of Electric Shock – This pump has not been investigated For Use In Swimming Pool or Marine Areas. Use appropriate measures to protect operator and equipment.*

**WARNING:** *Turn drive off before removing or installing tubing. Fingers or loose clothing could be caught in the drive mechanism.*



### **WARNING: PRODUCT USE LIMITATION**

These products are not designed for, nor intended for use in, patient-connected applications, including, but not limited to, medical and dental use, and, accordingly, have not been submitted for FDA approval.

## INTRODUCTION AND GENERAL DESCRIPTION

The MASTERFLEX® L/S® fixed flow drives provide continuous fixed speed pumping of fluids while power is supplied.

Different models provide various speeds as summarized:

Model#	Description	Speed (rpm)	Pump Heads Accepted
07540-01	L/S Fixed Speed, 115V AC, 60 Hz	1	2
07540-02	L/S Fixed Speed, 115V AC, 60 Hz	2	2
07540-06	L/S Fixed Speed, 115V AC, 60 Hz	6	2
07540-12	L/S Fixed Speed, 115V AC, 60 Hz	12	2
07540-20	L/S Fixed Speed, 115V AC, 60 Hz	20	2
07540-30	L/S Fixed Speed, 115V AC, 60 Hz	30	2
07540-60	L/S Fixed Speed, 115V AC, 60 Hz	60	1
07542-01	L/S Fixed Speed, 230V AC, 50 Hz	1	2
07542-02	L/S Fixed Speed, 230V AC, 50 Hz	2	2
07542-06	L/S Fixed Speed, 230V AC, 50 Hz	5	2
07542-12	L/S Fixed Speed, 230V AC, 50 Hz	10	2
07542-20	L/S Fixed Speed, 230V AC, 50 Hz	17	2
07542-30	L/S Fixed Speed, 230V AC, 50 Hz	25	2
07542-60	L/S Fixed Speed, 230V AC, 50 Hz	50	1

## SETUP AND OPERATION

**Use only MASTERFLEX precision tubing with MASTERFLEX pumps to ensure optimum performance.**

**Use of other tubing may void applicable warranties.**

Unpack the drive and retain all packing material until proper product operation has been verified. Select the pump head and tubing according to the flow desired, while considering chemical compatibility and tubing life. Pump installation instructions are included with the pump head. Connect the line cord to a grounded three-wire AC receptacle.

The following sketch shows the dimensional outline of the drive:

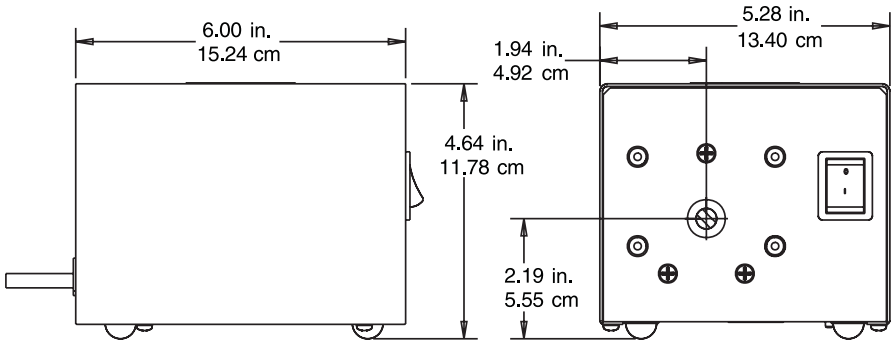

## MAINTENANCE

**WARNING: Remove power from the drive before attempting any maintenance.**



The rear motor bearing should be given two drops of #20 non-detergent oil every three months. **Do not over oil.** Clean off any accumulated dust or dirt. The drive gear/motor assembly can be replaced if necessary. Exact “life” will depend on the number of heads and the speed used.

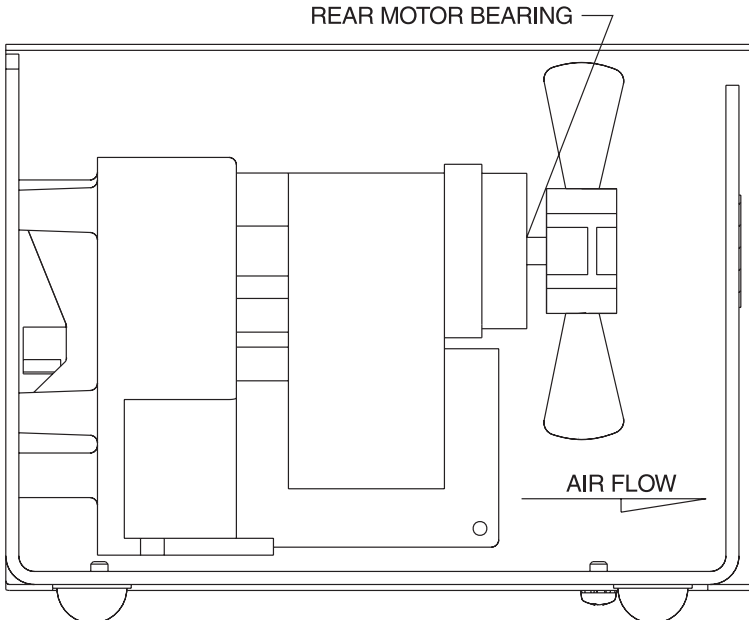



## SPECIFICATIONS (Cont.)

### Environment:

Operating Temperature:	0°C to 40°C
Storage Temperature:	-25°C to 65°C
Humidity:	10% to 90% non-condensing
Altitude:	Less than 2000 meters
Pollution Degree:	Pollution degree 2 (indoor usage—lab,office)

### Construction:

Dimensions (L x W x H):	15.2 cm x 13.4 cm x 11.8 cm (6 in x 5.3 in x 4.6 in)
Weight:	3 kgs (6.5 lbs)
Color:	Ghost Gray and black
Material:	Painted steel housing
Enclosure Rating:	IP22 per IEC 60529
Compliance:	115 V UL778, CSA G22.2 No. 108-01 230V (For CE Mark): EN61010-1 (EU Low Voltage Directive) and EN61326 (EU EMC Directive)

## WARRANTY

***Use only MASTERFLEX precision tubing with MASTERFLEX pumps to ensure optimum performance. Use of other tubing may void applicable warranties.***

The Manufacturer warrants this product to be free from significant deviations from published specifications. If repair or adjustment is necessary within the warranty period, the problem will be corrected at no charge if it is not due to misuse or abuse on your part as determined by the Manufacturer. Repair costs outside the warranty period, or those resulting from product misuse or abuse, may be invoiced to you.

***The warranty period for this product is 2 years from the date of purchase.***

## PRODUCT RETURN

To limit charges and delays, contact the seller or Manufacturer for authorization and shipping instructions before returning the product, either within or outside of the warranty period. When returning the product, please state the reason for the return. For your protection, pack the product carefully and insure it against possible damage or loss. Any damages resulting from improper packaging are your responsibility.

## TECHNICAL ASSISTANCE

If you have any questions about the use of this product, contact the Manufacturer or authorized seller.

### **MASTERFLEX<sup>®</sup>**

(US & Canada only) Toll Free 1-800-MASTERFLEX • 1-800-637-3739

(Outside US & Canada) 1-847-381-7050

masterflex.tech@avantorsciences.com

www.avantorsciences.com/masterflex

\*EN809 manufactured by:

Masterflex LLC

28092 W Commercial Avenue

Barrington, IL 60010

Printed in U.S.A.