



Cabinets & Casework

Customizable, secure, and organized

Includes:

- Freestanding Cabinets
- Customizable Casework
- Sinks and Countertops
- Console Cabinets

OUR MISSION

Customer Focus

Exceed customer expectations through a commitment to continuous improvement of our products and services.

Quality Products

Offer the marketplace a broad range of high quality, cost effective, and durable products of superior craftsmanship.

Organizational Excellence

Strive for excellence in all we do by fostering a participative, team based environment, which nurtures the active involvement of all members of the organization.

Marketplace Recognition

Earn the respect, admiration, and loyalty of our people, customers, and suppliers by treating them with dignity and respect, embracing diversity, and developing and maintaining long term partnerships.

Collaborative Workplace

Encourage all employees to work safely and efficiently, contribute innovative ideas, and personally benefit from the ongoing success of the company.

BLICKMAN

THE BLICKMAN DIFFERENCE

Freestanding Cabinets

- Our stainless steel cabinets are constructed with a seamless welded face preventing dirt collection while providing long lasting durability through unparalleled strength and corrosion resistance.
- Our freestanding cabinets rest on four legs with glides or can be mobilized on casters.
- Kay and Kennedy cabinets feature two separate sections with unlocked or locked compartments.
- Paul and Walter cabinets provide maximum storage room for large equipment.

Key Product Features

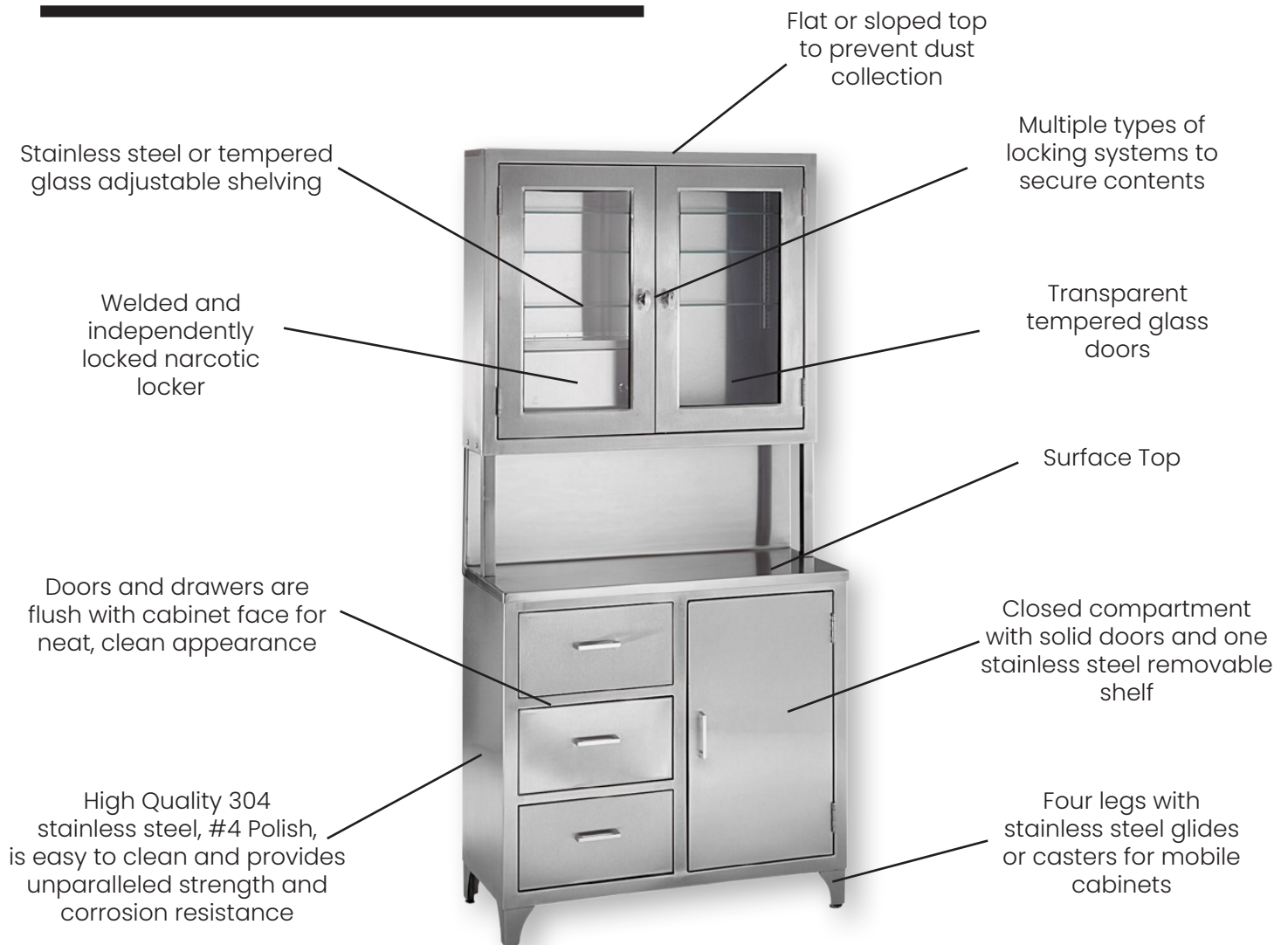

Cabinets

Freestanding

FREESTANDING

Description: Our Kay and Kennedy freestanding cabinets feature separate upper and lower sections. The upper sections of these cabinets are locked, transparent compartments for easily viewing and securing contents. The Kennedy cabinet includes an independently locked and welded narcotic locker.



Kay Cabinet

Upper section: Consists of a locked 29 3/4" x 31 3/8" x 15" compartment with a glass door and three removable glass shelves

Lower section: Consists of a 29 3/4" x 20 1/2" x 15" compartment with a stainless steel door and one stainless steel shelf



Kennedy Cabinet

Upper Section: 8" deep and contains a welded and independently locked narcotic locker

Lower Section: 16" deep and contains three 7" deep drawers and one 15" deep compartment

Name	Kay	Kennedy
Dimensions (WxHxD)	30" x 58" x 16"	36" x 76 1/2" x 16"
Model #	7953SS	7956SS
VWR Catalog #	76544-942	76544-944
Shipping Weight	219 lbs.	291 lbs.

Cabinets

Freestanding

FREESTANDING

Description: Our Paul and Walter cabinets are double door freestanding cabinets. They each come standard with two glass locked doors for securing contents. Our Walter cabinet is ideal for storing large instruments on its back pegboard, while our Paul cabinet includes shelving for storing lots of instruments and supplies. They are both 16" deep and 76" tall on gliders. They are 79 1/4" tall on casters.



Walter Cabinet

This cabinet is great for storing endoscopy equipment or other large instruments on its pegboard



Paul Cabinet

This cabinet provides maximum shelving storage for instruments and supplies. Glass shelves are adjustable every 1/2"

Name	Walter		Paul	
Width	35 5/8"W	47 5/8"W	35 5/8"W	47 5/8"W
			Glass Shelves	
Model #	7959SS	7960SS	7970SS	7971SS
VWR Catalog #	76544-946	76544-948	76544-950	76544-954
Shipping Weight	269 lbs.	310 lbs.	330 lbs.	400 lbs.
			Stainless Steel Shelves	
			7970SS-1	7971SS-1
			76544-952	76544-956
			330 lbs.	400 lbs.

Cabinets

FREESTANDING
Construction
Specifications

Construction Specifications

Standard Dimensions	All Freestanding Cabinets: 16" deep
Materials	304 stainless steel 1/4" clear tempered sheet glass
Gauge	Body, Sloped Top, Drawers, and Shelf Inserts: 18GA; Legs: 12GA Glass Doors (Front and Back): 18GA Solid Doors (Front): 18GA; Solid Doors (Back): 20GA
Welding	All welding by heliarc method and exposed welds are ground smooth
Finish	Exposed surfaces are free from pit marks, weld seams, scale and are polished with #4 polish to a satin finish
Casters	2" or 3" ball bearing, swivel casters with brakes
Notes	<ul style="list-style-type: none">• Kay: A counter weight is fastened underneath at bottom rear of cabinet for doors in open position. Upper door fitted with lock handle and three way latching device engaging at top.• Kennedy: Right hand door equipped with a locking knob and three way latching. Left hand door with dummy knob and roller latch. An independently locked narcotic cabinet, 13 1/4" x 5" x 7 3/4" with double walled door is welded to the bottom, back, and side of the compartment.• Paul & Walter: A counter weight is fastened underneath at bottom rear of cabinet for doors in open position. Right hand door is fitted with a locking handle and three point latching, and the left door has a dummy knob and spring loaded nylon roller catches.

Shipping Information

All shipping weights are estimates and may be changed without prior notice. Specifications may be improved and dimensions changed without prior notice. Please contact customer service for estimated shipping costs.

THE BLICKMAN DIFFERENCE

Casework

- Need more flexibility in today's space squeezed environment? We provide you with casework that can be assembled together and modified to fit your custom dimensions.
- Whether it is renovation or new construction, we will be happy to work with your facility's personnel, architects, contractors, and/or equipment planners to meet your custom requirements.
- Utilizing 3D Design Software REVIT®, we have developed a library of our standard products which is available at no charge to your company. Our 3D library will save you considerable time and money when working on projects that require stainless steel cabinets and equipment.
- Each product line of cabinets (console cabinets, high cabinets, base cabinets, and wall cabinets) have their individual properties identified for easy customization: (cubic feet, weight, "X", "Y" and "Z" dimensions, voltage, etc.).

Key Product Features

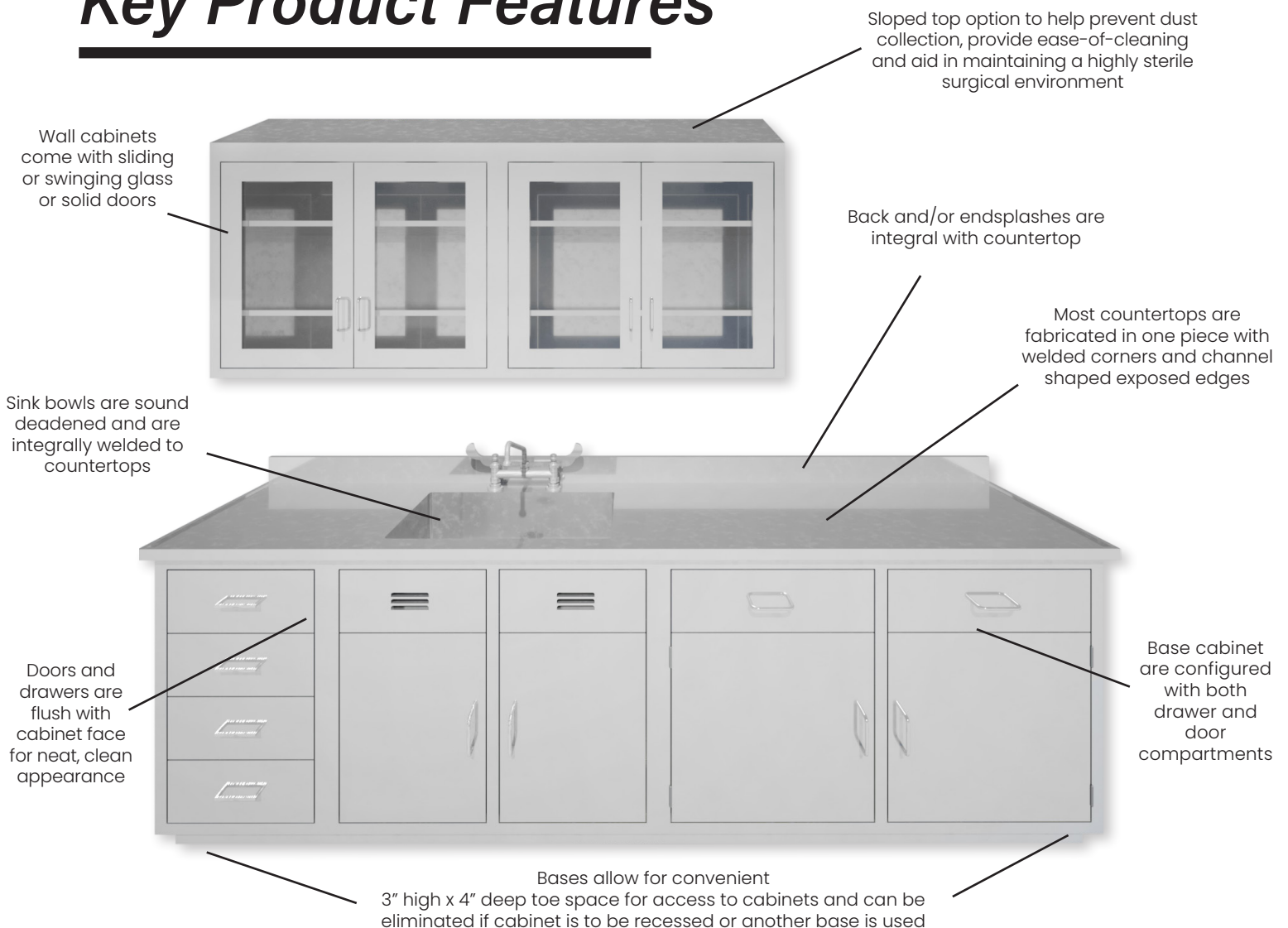

Cabinets

Customizable
Casework

HIGH CABINETS

Description: Our stainless steel high cabinets are designed to stand alone or fit within a framework of cabinets. They are constructed as floor and wall supported individual cases with finished sides. They each contain five adjustable stainless steel shelves.

Single Door



Glass Door

Dimensions (WxHxD)	18 3/4" x 84" x 18"	18 3/4" x 84" x 23"	24 3/4" x 84" x 18"	24 3/4" x 84" x 23"
Model #	K18HAS	K18HBS	K24HAS	K24HBS
VWR Catalog #	76545-162	76545-164	76545-014	76545-166
Shipping Weight	215 lbs.	235 lbs.	260 lbs.	275 lbs.

Solid Stainless Steel Door

Dimensions (WxHxD)	18 3/4" x 84" x 18"	18 3/4" x 84" x 23"	24 3/4" x 84" x 18"	24 3/4" x 84" x 23"
Model #	H18HAS	H18HBS	H24HAS	H24HBS
VWR Catalog #	76545-150	76545-152	76545-012	76545-154
Shipping Weight	230 lbs.	250 lbs.	255 lbs.	310 lbs.

Double Door

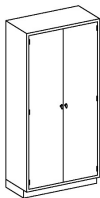
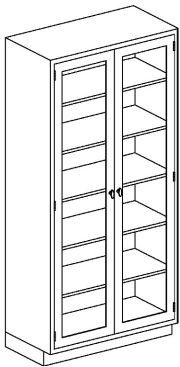

Glass Doors

Dimensions (WxHxD)	35" x 84" x 18"	35" x 84" x 23"	47" x 84" x 18"	47" x 84" x 23"
Model #	L35HAS	L35HBS	L47HAS	L47HBS
VWR Catalog #	76545-018	76545-168	76545-172	76545-176
Shipping Weight	310 lbs.	375 lbs.	390 lbs.	445 lbs.

Solid Stainless Steel Doors

Dimensions (WxHxD)	35" x 84" x 18"	35" x 84" x 23"	47" x 84" x 18"	47" x 84" x 23"
Model #	I35HAS	I35HBS	I47HAS	I47HBS
VWR Catalog #	76545-016	76545-156	76545-158	76545-160
Shipping Weight	300 lbs.	365 lbs.	380 lbs.	420 lbs.

Double Sliding Doors

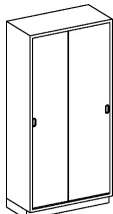
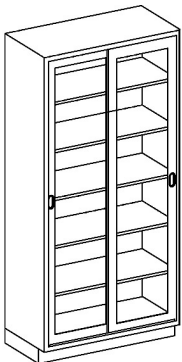

Glass Doors

Dimensions (WxHxD)	35" x 84" x 18"	35" x 84" x 23"	47" x 84" x 18"	47" x 84" x 23"
Model #	M35HAS	M35HBS	M47HAS	M47HBS
VWR Catalog #	76545-022	76545-180	76545-182	76545-184
Shipping Weight	325 lbs.	379 lbs.	385 lbs.	430 lbs.

Solid Stainless Steel Doors

Dimensions (WxHxD)	35" x 84" x 18"	35" x 84" x 23"	47" x 84" x 18"	47" x 84" x 23"
Model #	J35HAS	J35HBS	J47HAS	J47HBS
VWR Catalog #	76545-020	76545-170	76545-174	76545-178
Shipping Weight	347 lbs.	320 lbs.	420 lbs.	420 lbs.

Cabinets

Customizable
Casework

WALL CABINETS

Description: Our stainless steel wall cabinets are designed to stand alone with finished sides or to fit within a framework of cabinets. They are constructed for flush face wall surfaces with a recessed back panel for uneven wall surfaces.

Single Door

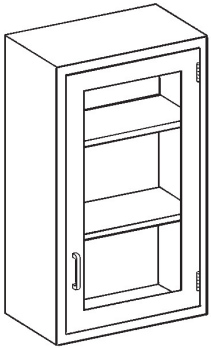

Hinged Glass Door

Dimensions (WxHxD)	18 3/4" x 30" x 13"	18 3/4" x 36" x 13"	18 3/4" x 48" x 13"	24 3/4" x 30" x 13"	24 3/4" x 36" x 13"	24 3/4" x 48" x 13"
Model #	D18LS	D18MS	D18HS	D24LS	D24MS	D24HS
VWR Catalog #	76545-110	76545-112	76545-114	76545-000	76545-016	76545-118
Shipping Weight	95 lbs.	110 lbs.	110 lbs.	110 lbs.	150 lbs.	120 lbs.

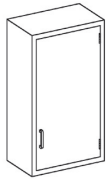

Solid Stainless Steel Doors

Dimensions (WxHxD)	18 3/4" x 30" x 13"	18 3/4" x 36" x 13"	18 3/4" x 48" x 13"	24 3/4" x 30" x 13"	24 3/4" x 36" x 13"	24 3/4" x 48" x 13"
Model #	A18LS	A18MS	A18HS	A24LS	A24MS	A24HS
VWR Catalog #	76545-090	76545-092	76545-094	76545-002	76545-096	76545-098
Shipping Weight	90 lbs.	80 lbs.	105 lbs.	115 lbs.	125 lbs.	165 lbs.

Double Door

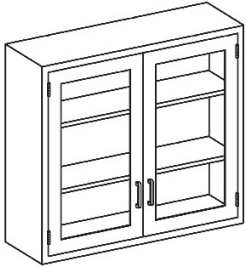

Hinged Glass Door

Dimensions (WxHxD)	35" x 30" x 13"	35" x 36" x 13"	35" x 48" x 13"	47" x 30" x 13"	47" x 36" x 13"	47" x 48" x 13"
Model #	E35LS	E35MS	E35HS	E47LS	E47MS	E47HS
VWR Catalog #	76545-006	76545-120	76545-122	76545-124	76545-126	76545-128
Shipping Weight	145 lbs.	150 lbs.	201 lbs.	175 lbs.	205 lbs.	210 lbs.

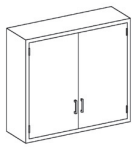

Solid Stainless Steel Door

Dimensions (WxHxD)	35" x 30" x 13"	35" x 36" x 13"	35" x 48" x 13"	47" x 30" x 13"	47" x 36" x 13"	47" x 48" x 13"
Model #	B35LS	B35MS	B35HS	B47LS	B47MS	B47HS
VWR Catalog #	76545-004	76545-100	76545-102	76545-104	76545-106	76545-108
Shipping Weight	141 lbs.	110 lbs.	155 lbs.	181 lbs.	195 lbs.	190 lbs.

Sliding Doors

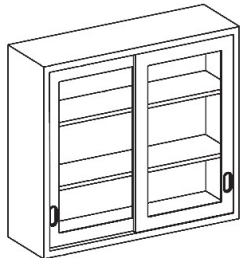

Sliding Glass Door

Dimensions (WxHxD)	35" x 30" x 13"	35" x 36" x 13"	35" x 48" x 13"	47" x 30" x 13"	47" x 36" x 13"	47" x 48" x 13"
Model #	F35LS	F35MS	F35HS	F47LS	F47MS	F47HS
VWR Catalog #	76545-010	76545-140	76545-142	76545-144	76545-146	76545-148
Shipping Weight	135 lbs.	165 lbs.	191 lbs.	180 lbs.	170 lbs.	220 lbs.

Cabinets

Customizable
Casework

OPEN CABINETS AND SHELVES

Description: Our stainless steel open wall cabinet is designed to stand alone with finished sides or fit within a framework of cabinets and comes with two adjustable stainless steel shelves. Alternatively, we offer a wall shelf that can be placed anywhere along a wall.

OPEN WALL CABINETS

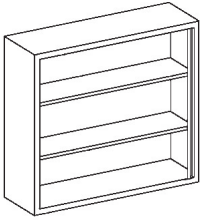

Width	35" W	35" W	35" W	47" W	47" W	47" W
Dimensions (WxHxD)	35" x 30" x 13"	35" x 36" x 13"	35" x 48" x 13"	47" x 30" x 13"	47" x 36" x 13"	47" x 48" x 13"
Model #	G35LS	G35MS	G35HS	G47LS	G47MS	G47HS
VWR Catalog #	76545-008	76545-130	76545-132	76545-134	76545-136	76545-138
Shipping Weight	75 lbs.	80 lbs.	90 lbs.	95 lbs.	105 lbs.	135 lbs.

OPEN BASE CABINETS

Description: Our stainless steel open base cabinets offer open shelving to fit within a framework of cabinets or stand alone with finished sides. They are constructed for flush face wall surfaces and come with two adjustable stainless steel shelves.

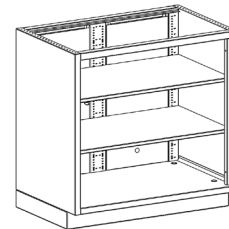
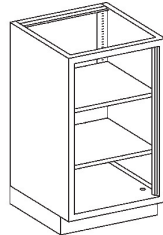

Name	Single Width		Double Width	
Width	18 1/8" W	24 1/8" W	35" W	47" W
Model #	AJ18HS	AJ24HS	AJ35HS	AJ47HS
VWR Catalog #	76545-052	76545-054	76545-056	76545-058
Shipping Weight	102 lbs.	122 lbs.	152 lbs.	170 lbs.



WALL SHELF

Width	36" W	36" W	48" W	48" W	60" W	60" W	72" W	72" W	84" W
Dimensions (WxD)	36" x 12"	36" x 16"	48" x 12"	48" x 16"	60" x 12"	60" x 16"	72" x 12"	72" x 16"	84" x 12"
Model #	WS3612	WS3616	WS4812	WS4816	WS6012	WS6016	WS7212	WS7216	WS8412
VWR Catalog #	76545-024	76545-026	76545-028	76545-030	76545-032	76545-034	76545-036	76545-038	76545-040
Shipping Weight	26 lbs.	33 lbs.	36 lbs.	41 lbs.	45 lbs.	53 lbs.	50 lbs.	64 lbs.	40 lbs.

Cabinets

Customizable
Casework

SINGLE BASE CABINETS

Description: Our stainless steel single width base cabinets come in five different configurations and are designed to stand alone with finished sides or to fit withing a framework of cabinets.

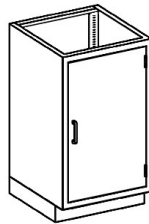

**-AA-
Door**



**-AB-
Door, Drawer**

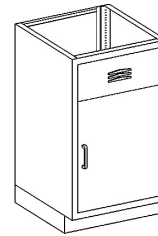

**-AC-
Door, Vent (Sink)**

Name	-AA- Door	-AB- Door, Drawer	-AC- Door, Vent (Sink)
		18 1/8" Wide	
Model #	AA18HS	AB18HS	AC18HS
VWR Catalog #	76545-042	76545-044	76545-046
Shipping Weight	80 lbs.	125 lbs.	107 lbs.

Name	-AA- Door	-AB- Door, Drawer	-AC- Door, Vent (Sink)
		24 1/8" Wide	
Model #	AA24HS	AB24HS	AC24HS
VWR Catalog #	76544-974	76544-972	76545-048
Shipping Weight	132 lbs.	147 lbs.	118 lbs.

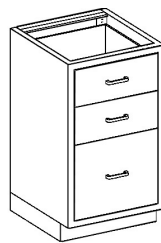

**-AS-
3 Drawer**

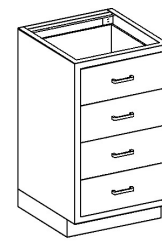

**-AE-
4 Drawer**

Name	-AS- 3 Drawer	-AE- 4 Drawer	
		18 1/8" Wide	
Model #	AS18HS	AE18HS	
VWR Catalog #	76545-060	76545-050	
Shipping Weight	167 lbs.	174 lbs.	

Name	-AS- 3 Drawer	-AE- 4 Drawer	
		24 1/8" Wide	
Model #	AS24HS	AE24HS	
VWR Catalog #	76544-970	76544-976	
Shipping Weight	183 lbs.	192 lbs.	

Note: Cabinets without vents include one stainless steel shelf inside

Cabinets

Customizable
Casework

DOUBLE BASE COMPARTMENT CABINETS

Description: Our stainless steel double base compartment cabinets come in seven different configurations and are designed to stand alone with finished sides or to fit within a framework of cabinets.

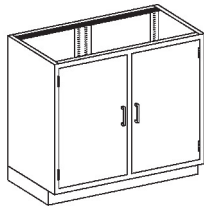

**-DA-
Double Door**

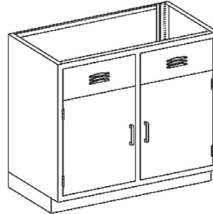

**-DB-
Double Vent (Sink)**



**-DC-
Large Drawer**



**-DD-
Double Drawer**

35" Wide

	DA35HS	DB35HS	DC35HS	DD35HS
Model #	DA35HS	DB35HS	DC35HS	DD35HS
VWR Catalog #	76544-984	76545-062	76544-980	76544-986
Shipping Weight	161 lbs.	145 lbs.	200 lbs.	194 lbs.

47" Wide

	DA47HS	DB47HS	DC47HS	DD47HS
Model #	DA47HS	DB47HS	DC47HS	DD47HS
VWR Catalog #	76545-070	76545-064	76545-066	76545-072
Shipping Weight	205 lbs.	178 lbs.	235 lbs.	243 lbs.



**-DG-
1 Door, 4 Drawer**



**-DJ-
1 Door, 8 Drawer**



**-DK-
1 Door, 5 Drawer**

35" Wide

	DG35HS	DJ35HS	DK35HS
Model #	DG35HS	DJ35HS	DK35HS
VWR Catalog #	76544-978	76545-076	76544-988
Shipping Weight	180 lbs.	225 lbs.	257 lbs.

47" Wide

	DG47HS	DJ47HS	DK47HS
Model #	DG47HS	DJ47HS	DK47HS
VWR Catalog #	76545-074	76545-080	76545-078
Shipping Weight	282 lbs.	280 lbs.	283 lbs.

Cabinets

Customizable
Casework

DOUBLE BASE DRAWER CABINETS

Description: Our stainless steel double base drawer cabinets come in five different configurations and are designed to stand alone with finished sides or to fit within a framework of cabinets.



**-DP-
4 Drawer**

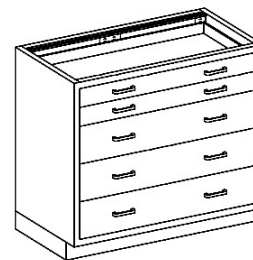

**-DS-
5 Drawer**

35" Wide		
Model #	DP35HS	DS35HS
VWR Catalog #	76544-994	76544-996
Shipping Weight	238 lbs.	275 lbs.

47" Wide		
Model #	DP47HS	DS47HS
VWR Catalog #	76545-082	76545-086
Shipping Weight	276 lbs.	315 lbs.



**-DT-
8 Drawer**



**-DR-
4 Small, 2 Large**



**-FC-
6 Small, 2 Large**

35" Wide			
Model #	DT35HS	DR35HS	FC35HS
VWR Catalog #	76544-998	76544-992	76544-982
Shipping Weight	287 lbs.	265 lbs.	275 lbs.

47" Wide			
Model #	DT47HS	DR47HS	FC47HS
VWR Catalog #	76545-088	76545-084	76545-068
Shipping Weight	324 lbs.	310 lbs.	323 lbs.

Cabinets

Customizable
Casework

COUNTERTOPS



Optional back/endsplashes (4" high) to protect wall surfaces

Counter top extends 1" past the front and past both sides of the base cabinet dimensions

Counter top is 304 stainless steel and comes standard with a Marine Edge to help protect against liquid slippage



Model #	VWR Catalog #	Height	Width	Depth	Shipping Weight	Description
EP2432	76545-218	32-3/4"	2"	24"	60	Counter End Panel Assembly with Adj Levelers
EP2635	76545-220	34-3/4"	32-3/4"	26"	52	Counter End Panel Assembly with Adj Levelers
C-TOP	76545-222	4"	24-1/8"	24"	43	Counter Assembly with 4" Backsplash
CT2429R	76545-224	4"	29"	24"	52	Counter Assembly with 4" Backsplash
CT3525	76545-226	4"	35"	25"	63	Counter Assembly with 4" Backsplash
C-TOP	76545-228	4"	47"	23"	92	Counter Assembly with 4" Backsplash
CT4724	76545-230	N/A	47"	24"	67	Counter Assembly w/o Backsplash
C-TOP	76545-232	N/A	65-1/4"	24"	90	Counter Assembly w/o Backsplash - Grommet Cutout
C-TOP	76545-234	4"	72"	25"	156	Counter Assembly with 4" Backsplash
C-TOP	76545-236	4"	95"	24"	196	Counter Assembly with 4" Backsplash
C-TOP	76545-238	4"	96"	25"	206	Counter Assembly with 4" Backsplash
C-TOP	76545-240	N/A	96"	36"	232	Counter Assembly w/o Backsplash
C-TOP	76545-242	4"	117"	24"	240	Counter Assembly with 4" Backsplash
C-TOP	76545-244	4"	96"	24"	198	Counter Assembly with 4" Backsplash
C-TOP	76545-246	N/A	35"	N/A	75	Counter ADA Apron Assembly

Cabinets

Customizable
Casework

DRAWER HOUSING

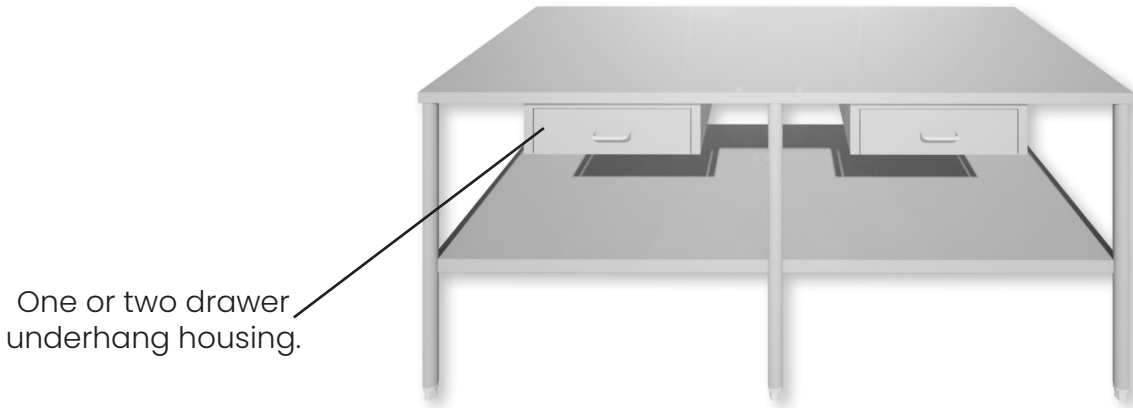

Description: You can use drawer housing to add a drawer or two under your countertop or tabletop surface. This helps increase storage space to prevent lack of access to equipment and supplies when stored separately.

All drawer housing is 22" deep and reaches 5" below the underside of the countertop or tabletop. Width of drawer housing varies depending on size and number of drawers inside. The drawers are all 18 1/8" deep and 2 1/2" tall and come in two width sizes: 14 1/8" and 20 1/8".

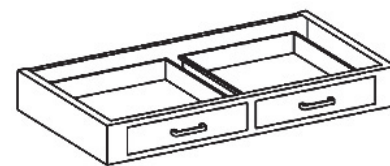
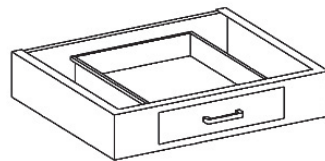

Name	Single Drawer		Double Drawer	
	14 1/8" W Drawer 24" W Housing	20 1/8" W Drawer 29" W Housing	14 1/8" W Drawer 35" W Housing	20 1/8" W Drawer 47" W Housing
Model #	DH124S	DH129S	DH235S	DH247S
VWR Catalog #	76545-186	76545-188	76545-190	76545-192
Shipping Weight	35 lbs.	40 lbs.	50 lbs.	60 lbs.

PARTS AND ACCESSORIES

SLOPE TOP



Description: Slope top assembly prevents dust collection on cabinet top. Great for sterile conditions.

High Cabinet Slope Top

Width	18-3/4"		24-3/4"		35"		47"	
Height x Depth	11-1/4"H x 18D	14"H x 23D	11-1/4"H x 18D	14"H x 23D	11-1/4"H x 18D	14"H x 23D	11-1/4"H x 18D	14"H x 23D
Model #	ST-1818	ST-1823	ST-2418	ST-2423	ST-3518	ST-3523	ST-4718	ST-4723
VWR Catalog #	76545-196	76545-198	76545-202	76545-204	76545-208	76545-210	76545-214	76545-216
Shipping Weight	14 lbs.	40 lbs.	32 lbs.	21 lbs.	18 lbs.	26 lbs.	23 lbs.	29 lbs.

Wall Cabinet Slope Top

Width	18-3/4"	24-3/4"	35"	47"
Height x Depth	8-1/4"H x 13D	8-1/4"H x 13D	8-1/4"H x 13D	8-1/4"H x 13D
Model #	ST-1813	ST-2413	ST-3513	ST-4713
VWR Catalog #	76545-194	76545-200	76545-206	76545-212
Shipping Weight	10 lbs.	12 lbs.	36 lbs.	42 lbs.

Cabinets

Construction Specifications

Standard Dimensions	High Cabinets: 84" tall x 18" deep, widths vary Wall Cabinets: 30" tall x 13" deep, widths vary Base Cabinets: 35 3/4" tall x 22" deep, widths vary Countertops: 1" overhang in front and both sides of base cabinets
Materials	304 Stainless Steel 1/4" clear tempered sheet glass
Gauge	Body, Sloped Top, Drawers, and Shelf Inserts: 18GA; Base: 16GA Glass Doors (Front and Back): 18GA Solid Doors (Front): 18GA; Solid Doors (Back): 20GA
Welding	All welding by heliarc method and exposed welds are ground smooth
Finish	Exposed surfaces are free from pit marks, weld seams, scale and are polished with #4 polish to a satin finish
Casters	N/A
Notes	<ul style="list-style-type: none">• Cabinet Parts:<ul style="list-style-type: none">• Hinge Doors: Hung on semi concealed stainless steel hinges and fitted with die cast aluminum bar pulls and spring loaded nylon roller catches.• Sliding Doors: Suspended from overhead ball bearing rollers, which are noiseless and self-lubricating, and ride in stainless steel guide strips fitted with die formed, recessed pulls securely welded in place.• Shelves: Constructed with a channel shaped, flanged edge and centers the full height of the cabinet.• Drawers: Drawer bodies are a one piece construction with covered corners. Drawer face equipped with die cast aluminum bar pole handles. Drawers operated on ball bearing roller slides with full extension.• High Cabinets & Wall Cabinets: Recessed pan back, 3/4" deep.• Base Cabinets: Each applied with a channel shaped base, incorporating toe space approximating 3" deep and 4" high, for easy cabinet access. Can be omitted when recessed or another base is used.• Sinks and Countertops: Fabricated in one piece, where possible, with welded corners, channel shaped exposed edges, and reinforced with three full length hat shaped galvaneal channels.

Shipping Information

All shipping weights are estimates and may be changed without prior notice. Specifications may be improved and dimensions changed without prior notice. Please contact customer service for estimated shipping costs.

THE BLICKMAN DIFFERENCE

Console Cabinets

- Our console cabinets are designed with you in mind. Without taking up valuable floor space, choose these cabinets for storing a full scheduled day, protecting your sterile supplies behind closed doors, and allowing instant access to supplies and equipment to minimize procedural delays.
- We offer individual units that can be combined and assembled into your own custom console arrangements. You can easily design your own by selecting cabinets with solid or glass doors available with or without locks. Locks can be keyed alike or independently. Stainless steel perimeter recessing trim may be purchased with all built-in installations.
- We offer units with shelving, good for storing equipment and supplies and other units with pegboard backs, great for storing large pieces of equipment.
- We also offer a desk cabinet with drawers, a sloped writing surface, and a dry erase board.

Key Product Features

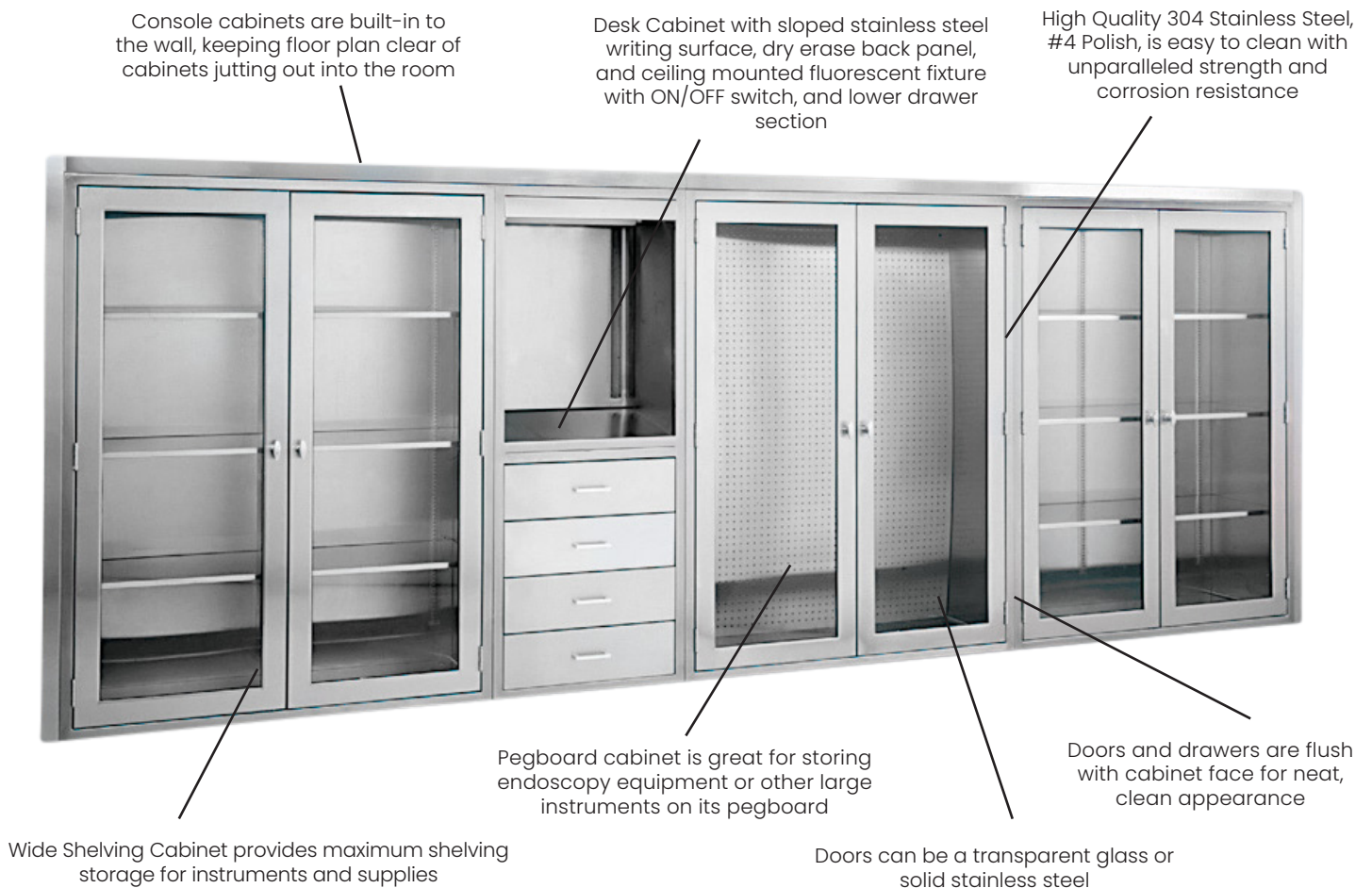

Cabinets

Console Cabinets

SINGLE WIDTH

Description: Our single width console cabinets are 24 1/8" x 60" x 18" and are designed as individual units that can be combined and assembled into your own custom console arrangements. All doors and shelves come in glass or solid stainless steel. Drawers are all stainless steel.

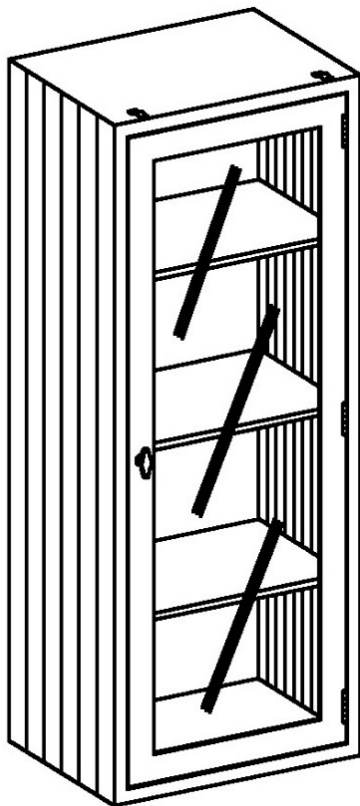

Miscellaneous Supply Cabinet

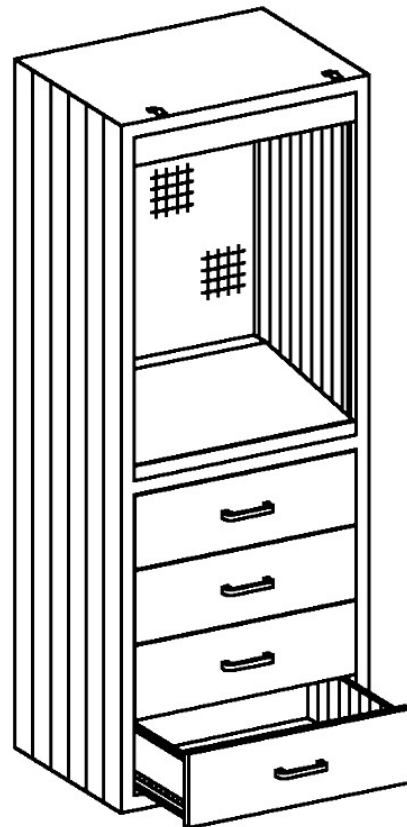

Desk Console Cabinet

	Glass Door	Drawers
Model #	MS24	DC24
VWR Catalog #	76544-964	76544-958
Shipping Weight	240 lbs.	245 lbs.

Cabinets

Console Cabinets

DOUBLE WIDTH

Description: Our double width console cabinets are all designed as individual units that can be combined and assembled into your own custom console arrangements. All doors and shelves come in glass or solid stainless steel. They are both 60" high and 18" deep and come in two width sizes: 35" and 47".



Name

Equipment & Supplies Console Cabinet

Table Accessories Console Cabinet

	Glass Door	35" W	Solid Door
Model #	ES35		TA35
VWR Catalog #	76544-960		76544-966
Shipping Weight	250 lbs.		250 lbs.
		47" W	
Model #	ES47		TA47
VWR Catalog #	76544-962		76544-968
Shipping Weight	275 lbs.		355 lbs.

Cabinets

CONSOLE CABINET
Construction
Specifications

Construction Specifications

Standard Dimensions	All console cabinets are 16" high x 18" deep, widths vary Exception: warming cabinets are 20" deep
Materials	304 Stainless Steel 1/4" clear tempered sheet glass
Gauge	Body, Sloped Top, Drawers, and Shelf Inserts: 18GA Glass Doors: Front and Back: 18GA Solid Doors (Front): 18GA; Solid Doors (Back): 20GA
Welding	All welding by heliarc method and exposed welds are ground smooth
Finish	Exposed surfaces are free from pit marks, weld seams, scale and are polished with #4 polish to a satin finish
Casters	N/A
Notes	<ul style="list-style-type: none">• All Console Cabinets: Solid doors are double panned, channel reinforced. Glass doors come in double shell design, with one piece outer frames dieformed to receive rubber gasketed glass panels held in place by inner retaining strips.• Double Door Console Cabinets: Right door fitted with two point up and down knob latching, left hand door with integral stops, dummy knob, and spring loaded nylon roller catch. Doors operate on three semi-concealed stainless steel hinges. Pegboard Cabinet interiors (back and sides) are lined with removable 18GA stainless steel pegboard.• Desk Console Cabinet: Four drawers with double wall fronts operate on side mounted, two section ball bearing roller slides with built-in extension stops. Heads provided with diecast aluminum bar pulls.• Single Door Shelving Console Cabinet: Can be either right or left hinged.• Recessed Warming Cabinets: Temperature control from 90°F - 160°F. 160x180 pixel graphical display with dual colors (red/green). Built-in temperature data recorder with real time clock (RTC).

Shipping Information

All shipping weights are estimates and may be changed without prior notice. Specifications may be improved and dimensions changed without prior notice. Please contact customer service for estimated shipping costs.

BLICKMAN

OUR PROMISE

For over 100 years, Blickman has been known throughout the healthcare industry for exceptional product quality. We pride ourselves on providing high-end and personalized service to ensure 100% customer satisfied. If you are not completely satisfied for any reason, we will make it right. All of our equipment is backed by our Limited Lifetime Warranty, so you can be certain that you have made the very best choice for your healthcare facility.

 **avantor**[™]
delivered by **VWR**[™]

VWR.COM

Prices, product, and/or services details are current when published and subject to change without notice. | Certain products or services may be limited by federal, state, provincial, or local regulations. | VWR, part of Avantor, makes no claims or warranties concerning sustainable/green products. Any claims concerning sustainable/green products are the sole claims of the manufacturer and not those of VWR International, LLC and/or Avantor, Inc. or affiliates. All prices are in US dollars unless otherwise noted. Offers valid in US and Canada unless otherwise noted, void where prohibited by law or company policy, while supplies last. | Trademarks are owned by Avantor, Inc. or its affiliates, unless otherwise noted. | Visit vwr.com to view our privacy policy, trademark owners, and additional disclaimers. © 2022 Avantor, Inc. All rights reserved.