

Start up Guide

# P2-Series

---

**Balances**

# 1. CONTENT

Models: VWR-203P2

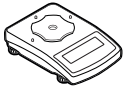

Balance  
x1



Draft shield  
x1



Weighing pan  
x1



Power adapter  
x1

Models: VWR-602P2 | VWR-2002P2 | VWR-3101P2



Balance  
x1



Draft shield  
x1



Weighing pan  
x1



Power adapter  
x1

*\*The plug type may vary by country.*

# 2. UNPACKING

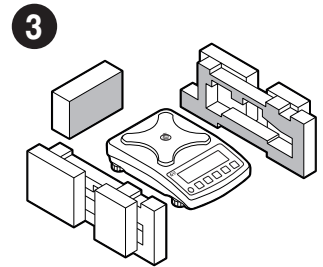
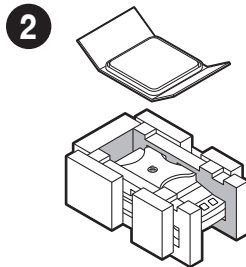
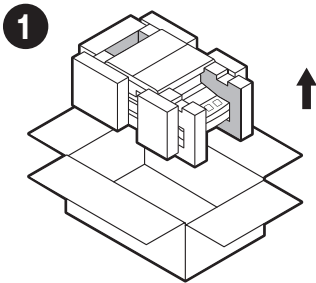

Keep the packaging should a warranty claim or service be required.

### 3. RECOMMENDATIONS AND WARNINGS

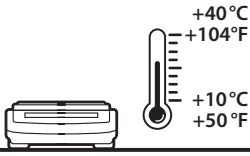

Operate the device in a room where the temperature ranges between 10–40 °C (50–104 °F) and where the relative humidity is below 80%.

Place the balance on a solid surface to ensure stability. To obtain stable and repeatable weighing results, an anti-vibration table is recommended.

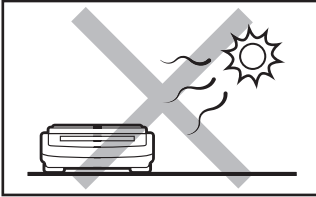

Place the balance away from heat sources. Avoid exposing the balance to the sunlight.

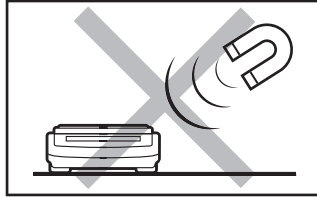

Avoid exposing the balance to a magnetic field. Do not weigh magnetic substances.

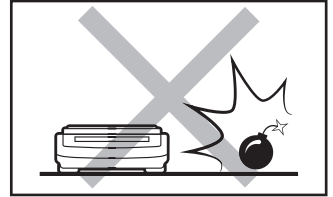

Do not place the balance in a hazardous area. Do not weigh explosive materials.

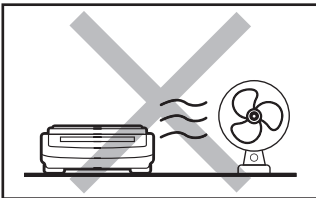

Avoid air drafts and air movements at the workstation.

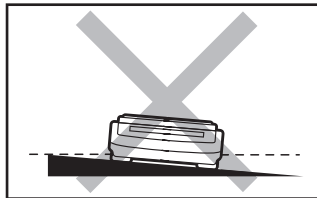

Make sure that the balance is placed on an even surface.

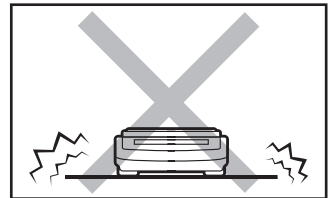

Do not place the balance on an unstable ground exposed to shocks and vibrations.

### 4. ACTIVITIES TO BE DONE PRIOR TO OPERATION

#### 4.1. Grounding spring check

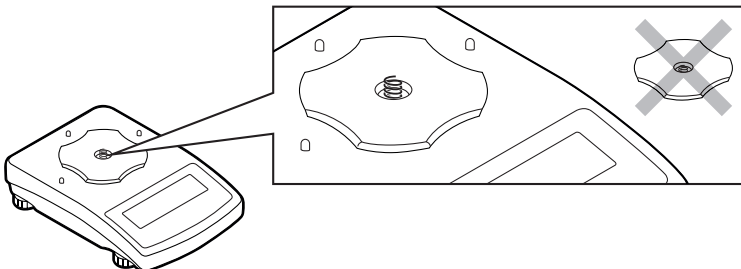

## 5. COMPONENTS ASSEMBLY

Models: VWR-203P2

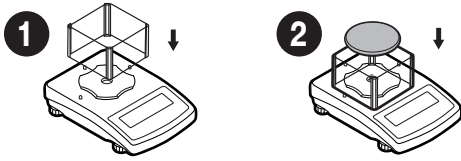

Models: VWR-602P2 | VWR-2002P2 | VWR-3101P2

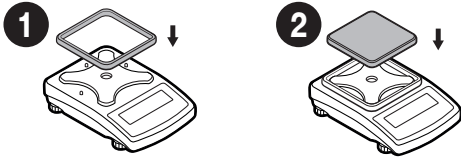

## 6. PREPARING FOR WORK

### 6.1. Temperature stabilization time

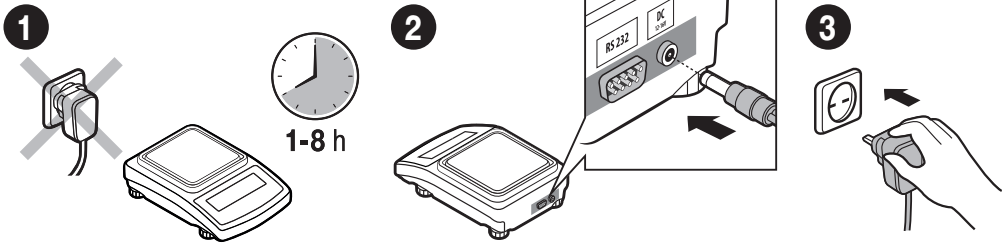

Prior to switching the device on, let it reach room temperature (estimated stabilization time: 1-8 hours).

Connect the power adapter to DC connector.

Connect the power adapter to the mains.

### 6.2. Leveling

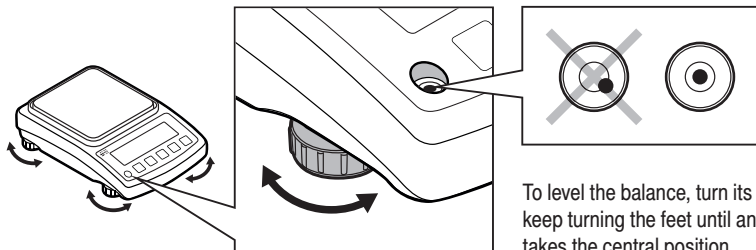

To level the balance, turn its feet and keep turning the feet until an air bubble takes the central position.

## 6.3. Switch the balance on

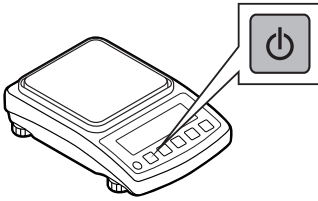

Your balance is ready to use!

To switch the device on, press ON / OFF key.

## 7. PANEL AND SCREEN

### 7.1. Panel keys

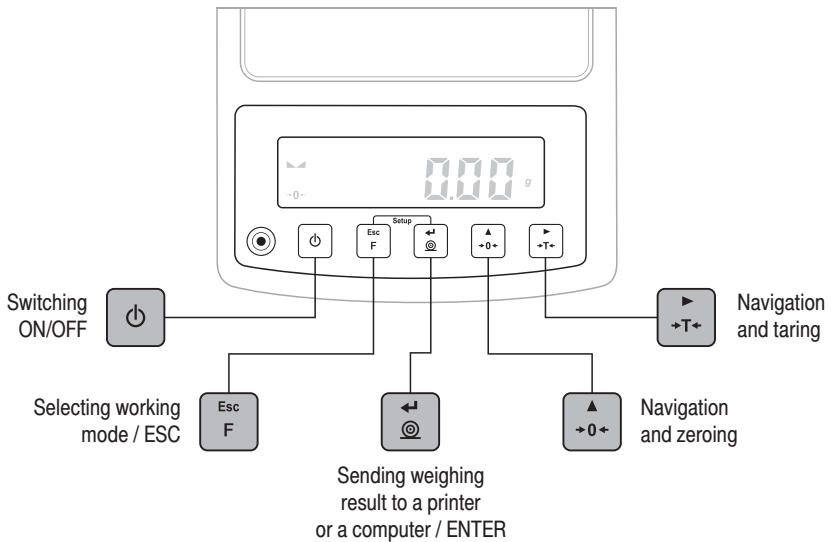

### 7.2. Home screen

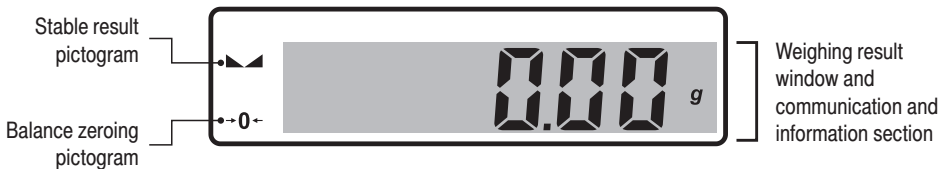

## 8. BASIC OPERATIONS

### 8.1. Adjustment

External adjustment is carried out using an external mass standard of the right accuracy and weight value, which value depends on balance type and capacity.



**Prior to adjustment prepare the right mass standard. You are recommended to use a mass standard of class F1 or F2. View the table and select the mass standard you need.**

Balance model	Mass standard [g]
VWR-203P2	200
VWR-602P2	500
VWR-2002P2	2 000
VWR-3101P2	2 000

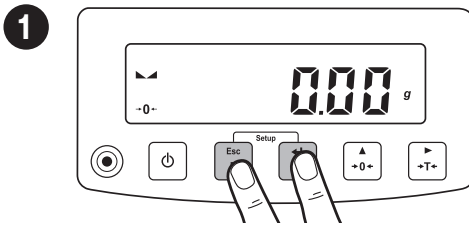

Simultaneously press **Esc** + **Setup** keys to enter home screen.

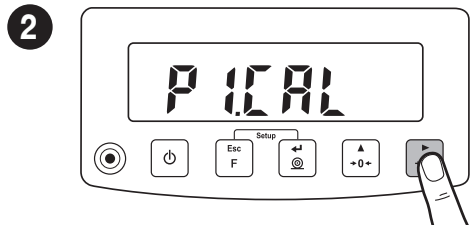

While "P1.CAL" parameter is on, press **→** key.

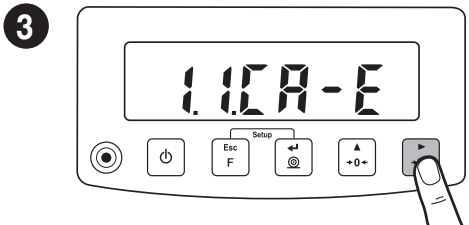

While "1.1.CA-E" parameter is on, press **→** key.

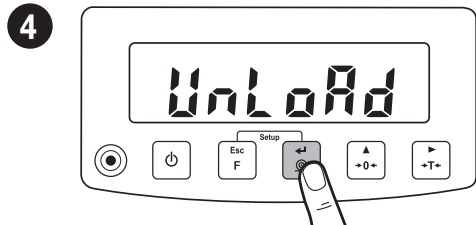

Unload the weighing pan and press **@** key.

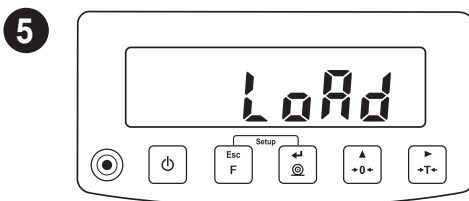

Prepare suitable mass standard.

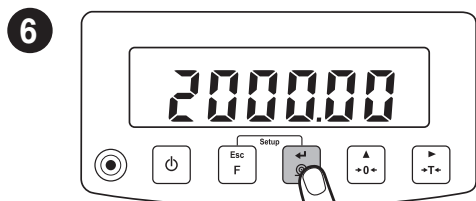

Load the weighing pan with the mass standard and press **@** key.

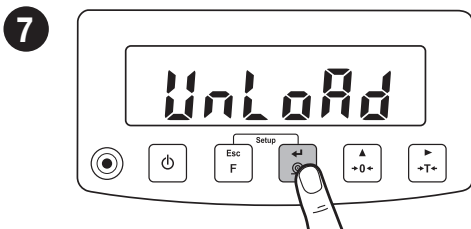

Unload the weighing pan.

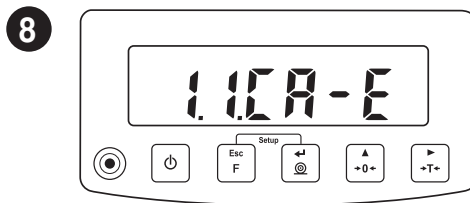

Adjustment completed.

## 8.2. Zeroing

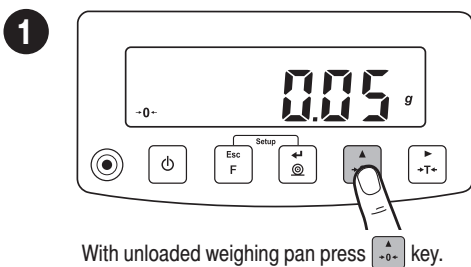

With unloaded weighing pan press  key.

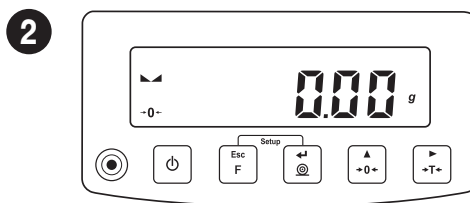

The balance has been zeroed.

## 8.3. Taring

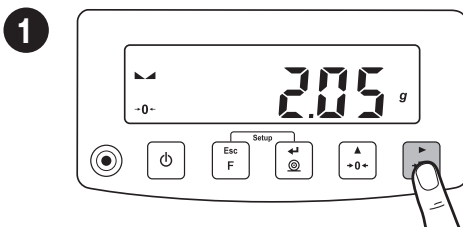

With loaded weighing pan, upon result stabilization, press  key.

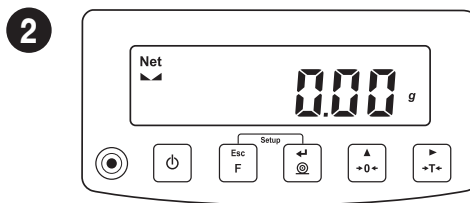

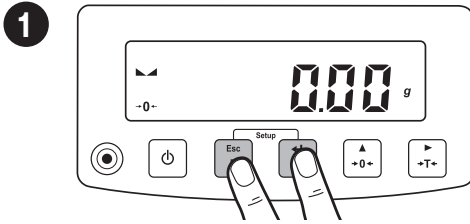

The balance has been tared.

## 8.4. Working modes accessibility

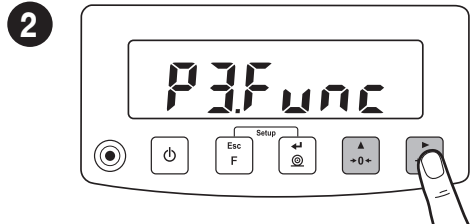

Simultaneously press  +  keys to enter home screen.



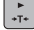

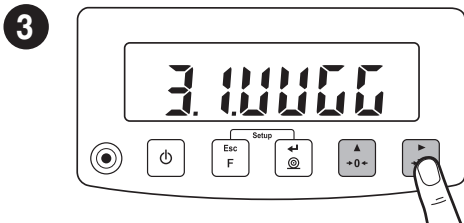
Using  key select "P3.Func" parameter and press  key.



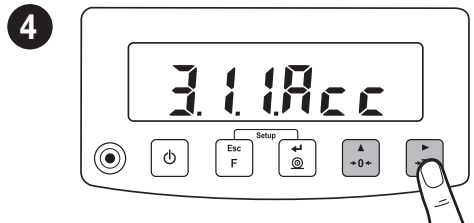

While "3.1.UUGG" parameter is on, press  key.

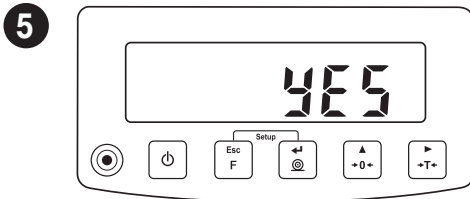

Using  key select "3.1.1.Acc" parameter and press  key.



Using  key select "YES" value and press  key to confirm.



In order to enable other working modes, repeat the steps: **3** and **4**. Save working mode settings - section **5**.



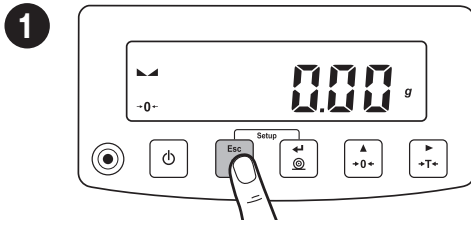

## 8.5. Selecting working mode

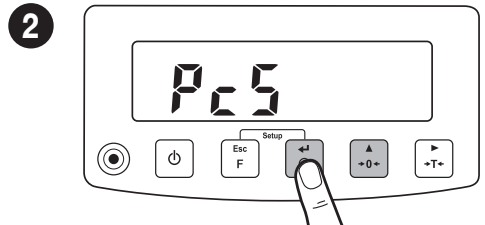

Using  key enter working modes menu.



Using  key select working mode and press .

The menu features the following working modes:

- Weighing
- Parts counting
- +/- Control
- Percent Weighing
- Peak Hold
- Totalising



Detailed overview of the settings of the working modes is to be found in balance's main user manual.

## 8.6. Weighing unit selection



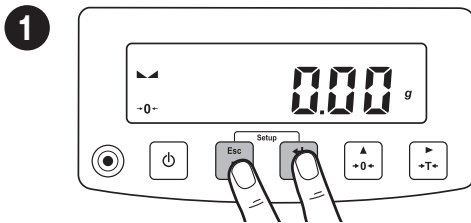

When the main unit is g (gram), the user has the following units: g (gram), ct (karat), lb (pound).



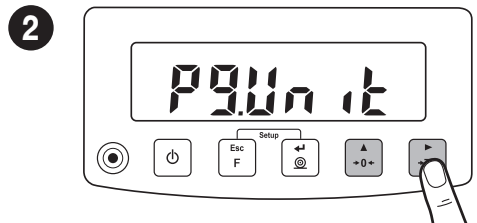

Simultaneously press  +  keys to enter home screen.



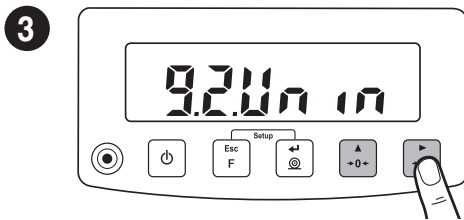

Using  key select "P9.Unit" parameter and press  key.

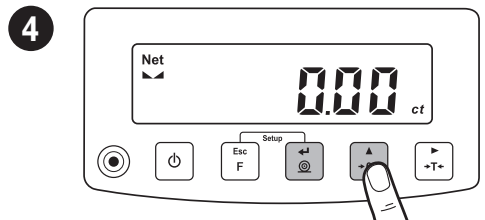

Using  key select "9.2.Unin" parameter and press  key.



Using  key select weighing unit and press  key to confirm.

# 9. PERIPHERAL DEVICES CONNECTORS

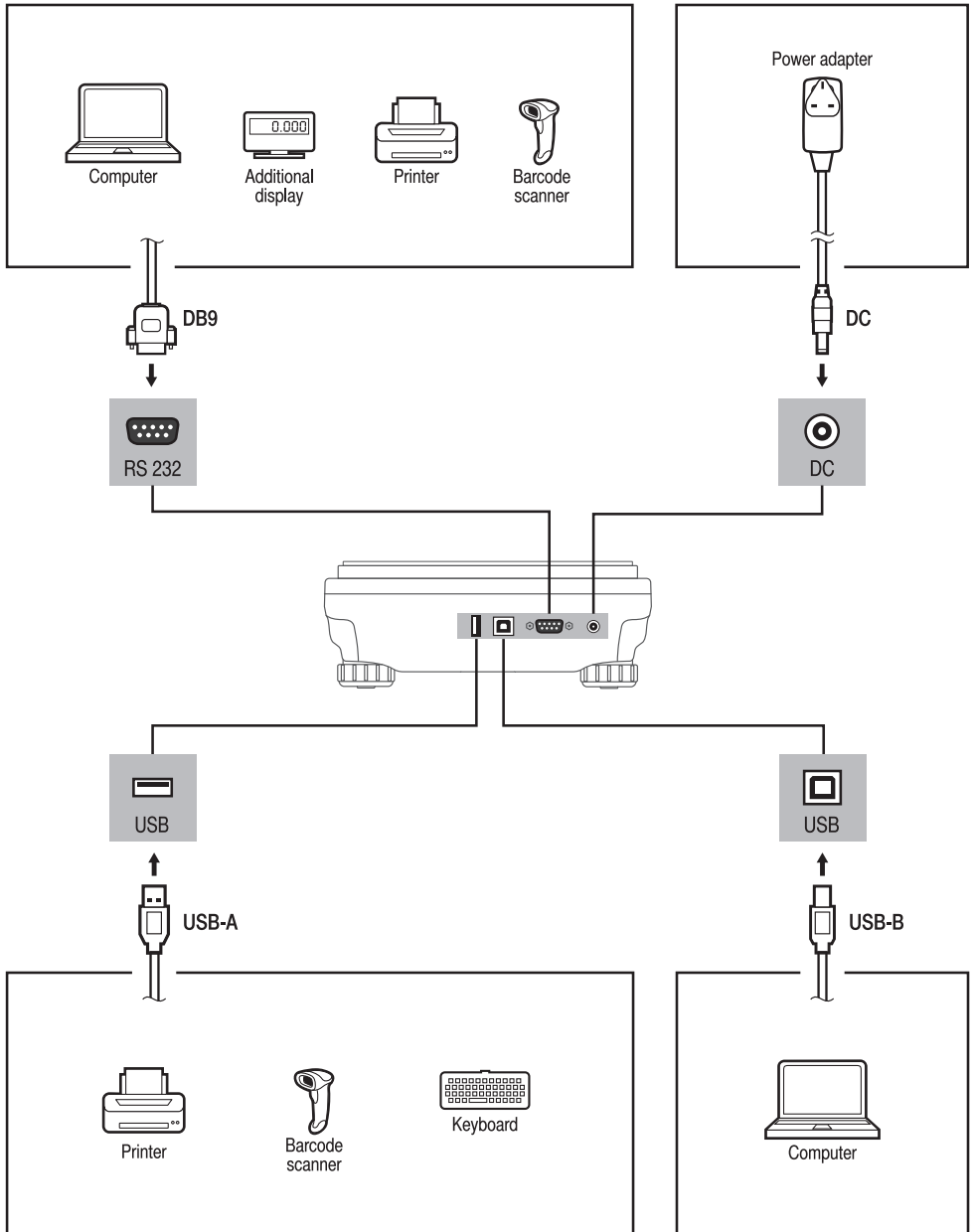

## 10. DEVICE CLEANING

### 10.1. General Recommendations

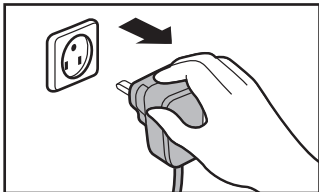

Prior to cleaning, it is necessary to disconnect the balance from the mains.

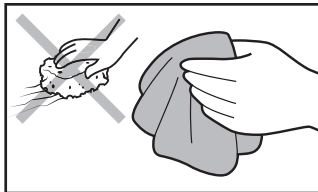

Use soft cloths made of microfiber, natural fiber or man-made fiber. Avoid using abrasive cloths or cloths that might scratch the surface.

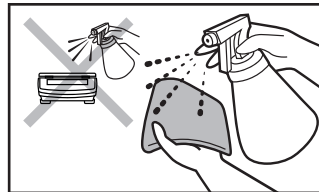

Apply the cleanser onto the cloth first. Avoid applying the cleanser directly onto the device.



**Avoid using cleansers containing chlorine, corrosive chemicals and bleach. Do not use cleansers containing abrasive substances or scouring preparations.**

### 10.2. Plastic components

**Prior to cleaning the plastic housing, it is necessary to disassemble weighing pan components (cover, weighing pan, etc.).**

Clean plastic components using a solution of water and detergent (liquid soap, dish-washing detergent, glass cleaner, etc.).

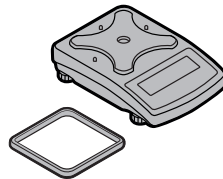

### 10.3. Stainless steel components

**Prior to cleaning the stainless steel components, it is necessary to disassemble them first.**

Clean stainless steel components using a solution of water and detergent (liquid soap, dish-washing detergent, glass cleaner, etc.). In case of heavy contamination, a mild solution of vinegar or baking soda can be used.

