

Start up Guide

P2.H-Series

Balances

1. CONTENT

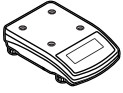

Balance
x1



Weighing pan
x1



Grounding foot
x1



Foot
x3

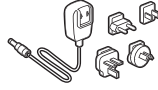

Power adapter*
x1

**The plug type may vary by country.*

2. UNPACKING

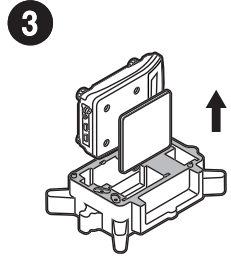
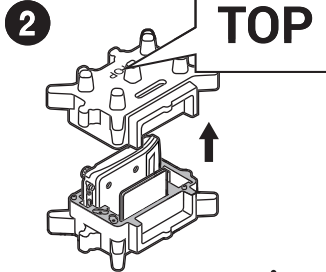
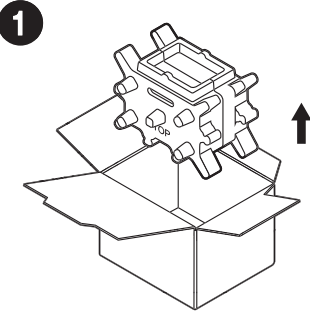

Keep the packaging should a warranty claim or service be required.

3. RECOMMENDATIONS AND WARNINGS

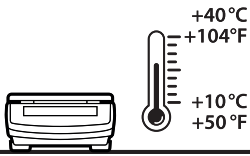

Operate the device in a room where the temperature ranges between 10–40 °C (50–104 °F) and where the relative humidity is below 80%.

Place the balance on a solid surface to ensure stability. To obtain stable and repeatable weighing results, an anti-vibration table is recommended.

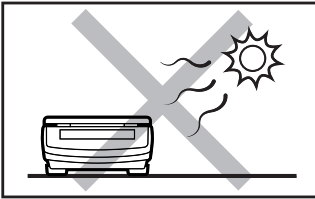

Place the balance away from heat sources. Avoid exposing the balance to the sunlight.

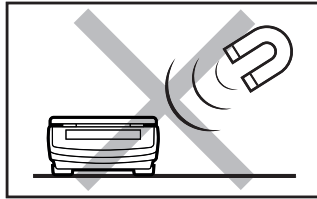

Avoid exposing the balance to a magnetic field. Do not weigh magnetic substances.

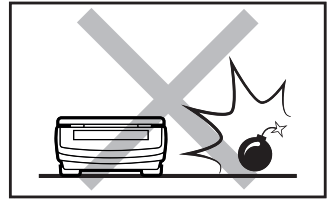

Do not place the balance in a hazardous area. Do not weigh explosive materials.

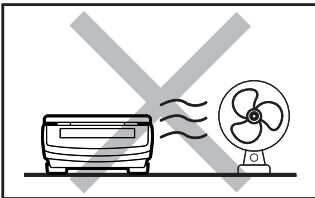

Avoid air drafts and air movements at the workstation.

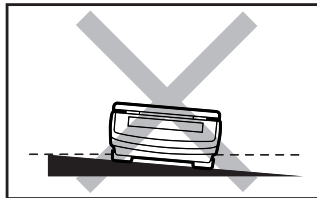

Make sure that the balance is placed on an even surface.

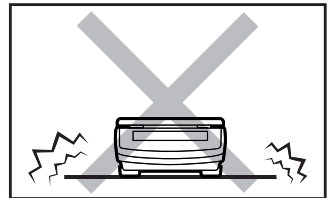

Do not place the balance on an unstable ground exposed to shocks and vibrations.

4. ACTIVITIES TO BE DONE PRIOR TO OPERATION

4.1. Grounding spring check

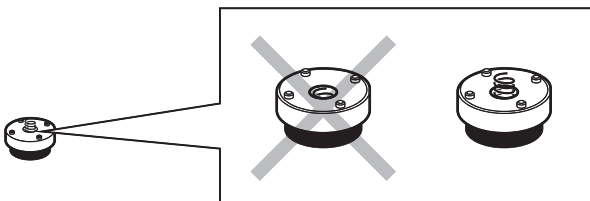

Check whether the grounding spring takes its intended location.

Make sure that the grounding spring juts slightly out of the hole.

5. COMPONENTS ASSEMBLY

1

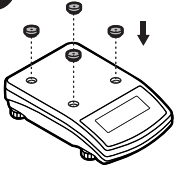

Install the grounding foot in a freely selected opening.

2

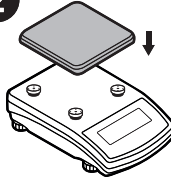

6. PREPARING FOR WORK

6.1. Temperature stabilization time

1

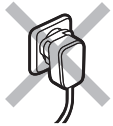

1-8 h

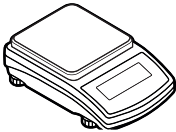

Prior to switching the device on, let it reach room temperature (estimated stabilization time: 1-8 hours).

2

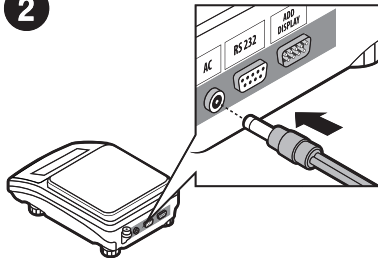

Connect the power adapter to AC connector.

3

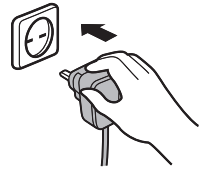

Connect the power adapter to the mains.

6.2. Leveling

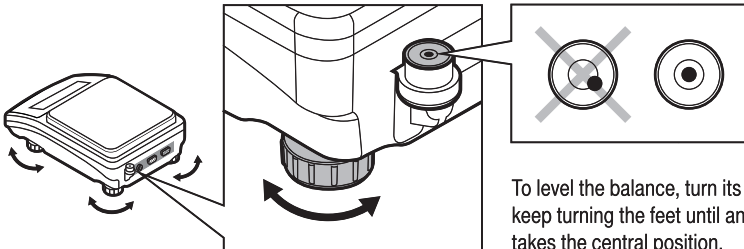

To level the balance, turn its feet and keep turning the feet until an air bubble takes the central position.

6.3. Switch the balance on

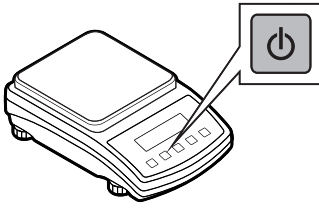

Your balance is ready to use!

To switch the device on, press ON / OFF key.

7. PANEL AND SCREEN

7.1. Panel keys

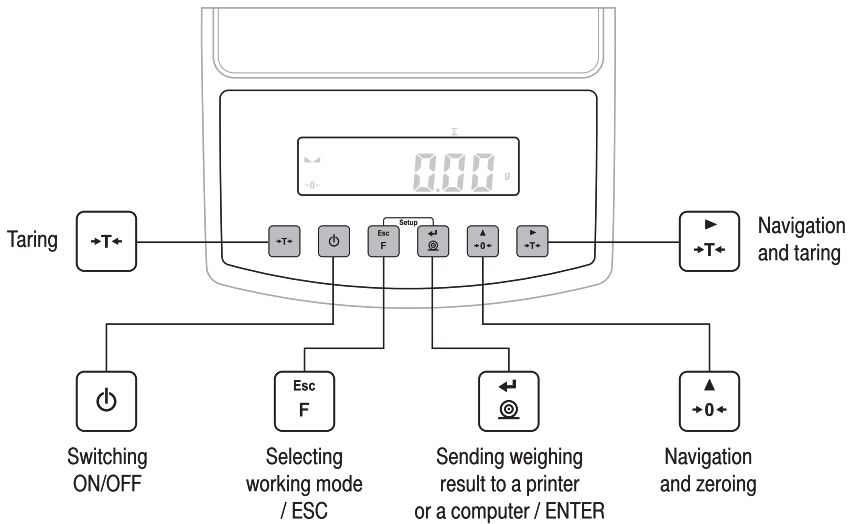

7.2. Home screen



8. BASIC OPERATIONS

8.1. Adjustment

External adjustment is carried out using an external mass standard of the right accuracy and weight value, which value depends on balance type and capacity.



Prior to adjustment prepare the right mass standard. You are recommended to use mass standard of class F1 or F2. View the table and select the mass standard you need.

Balance model	Mass standard [g]
VWR-6001P2.H	5 000
VWR-10001P2.H	10 000
VWR-20001P2.H	20 000

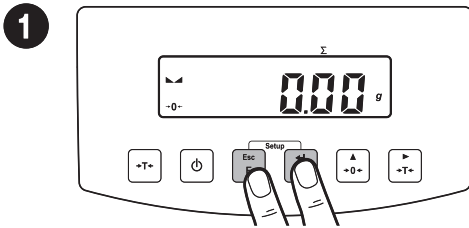

Simultaneously press + keys to enter home screen.

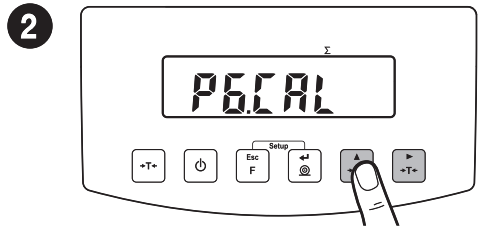

Using key select "P6.CAL" parameter and press key.

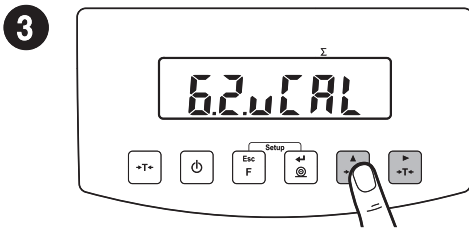

Using key select "6.2.uCAL" parameter and press key.

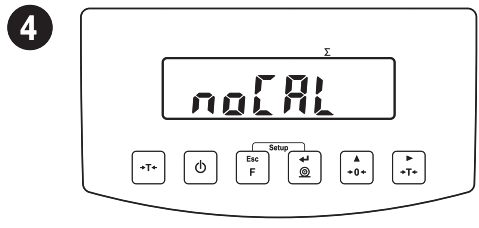

Wait for completion of the start mass determination process.

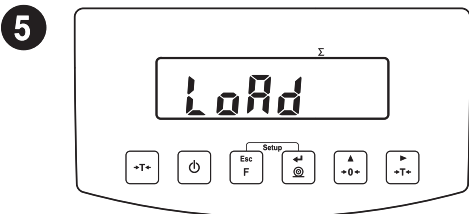

Prepare suitable mass standard.

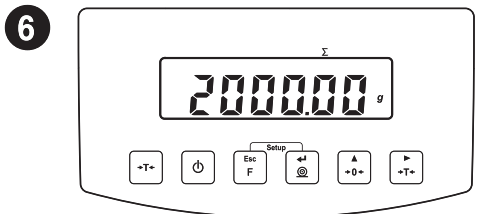

Load the weighing pan with the mass standard.

7

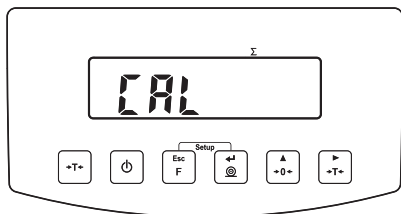

Wait for the adjustment completion.

8

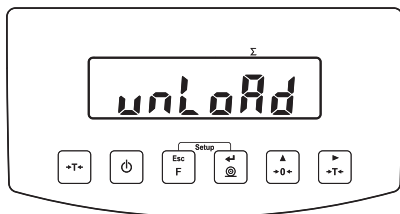

Unload the weighing pan.

9

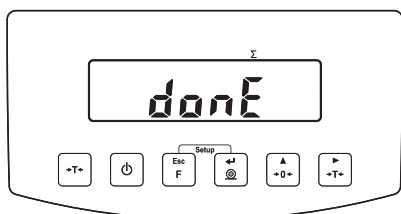

Adjustment completed.

10

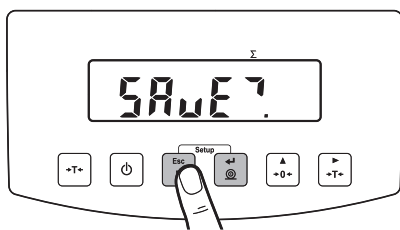

Using **Esc F** key select "SAVE?" parameter and press **→** key to save the adjustment.

8.2. Zeroing

1

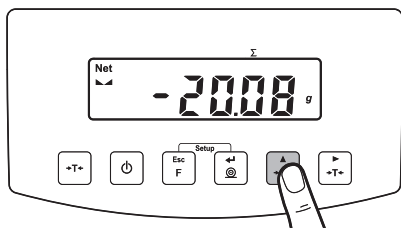

With unloaded weighing pan press **-0-** key.

2

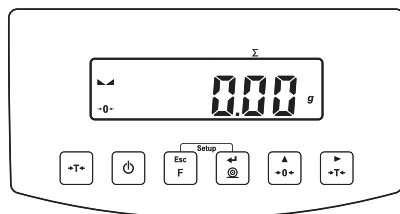

The balance has been zeroed.

8.3. Taring

1

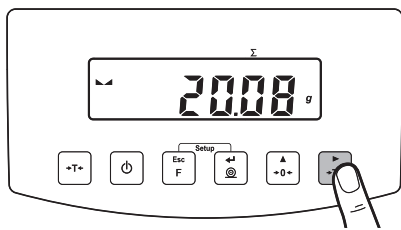

With loaded weighing pan, upon result stabilization, press **→** key.

2

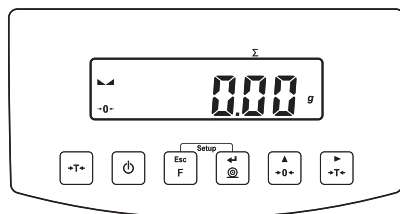

The balance has been tared.

8.4. Working modes accessibility

1

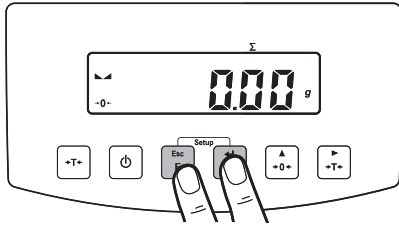

Simultaneously press + keys to enter home screen.

2

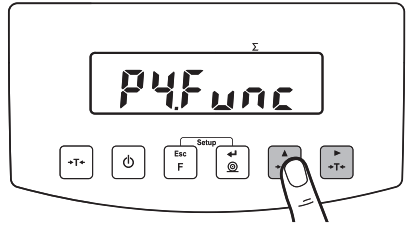

Using key select "P4.Func" parameter and press key.

3

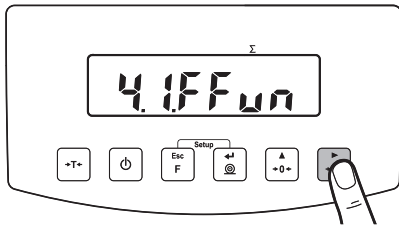

To enter lower menu level, when in "4.1.FFun" parameter, press key.

4

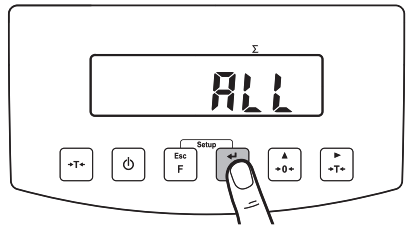

In "ALL" parameter, press key to enter lower menu level.

5

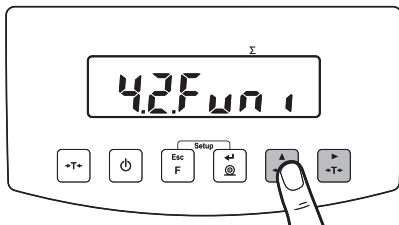

Select "4.2.Funi" parameter using key and press to enter lower menu level.

6

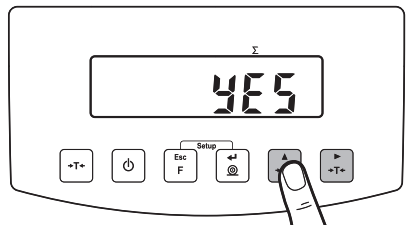

Using key select "YES" value and press key to confirm.

7

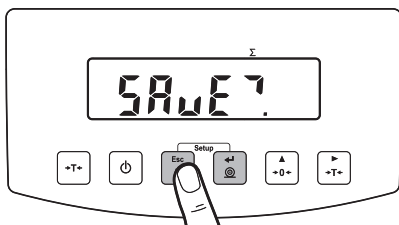

Using key select "SAVE?" value and press key to confirm settings.



In order to enable other working modes, repeat the steps: **5** and **6**. Save working mode settings - section **7**.

8.5. Selecting working mode



In order to be able to select working modes, it is necessary to make them available first (section 8.4).

1

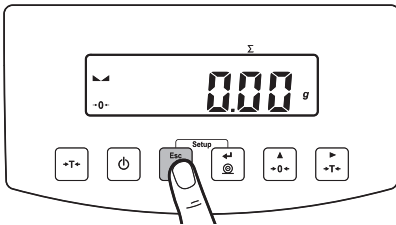

Using **Esc F** key enter working modes menu.

2

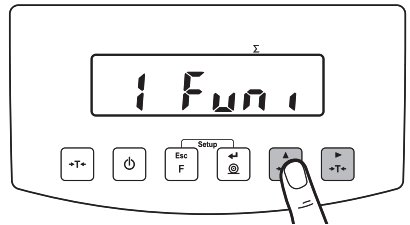

Using **▲ -0-** key select working mode and press **▶ -T+**.

The menu features the following working modes:

- Parts counting
- Percent weighing
- Checkweighing
- Animal weighing
- Totalising
- Peak hold
- Measurement in Newton



Detailed overview of the settings of the working modes is to be found in balance's main user manual.

8.6. Weighing unit selection

1

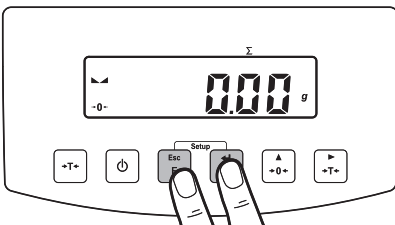

Simultaneously press **Esc F** + **▲ -0-** keys to enter home screen.

2

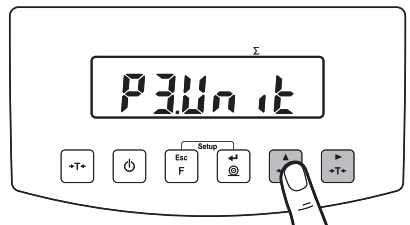

Using **▶ -T+** key select "P3.Unit" parameter and press **▲ -0-** key.

3

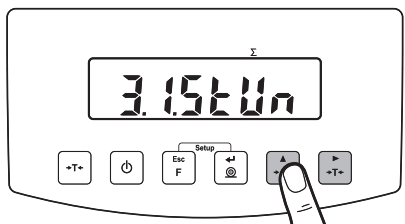

In "P3.Unit" parameter press key.

4

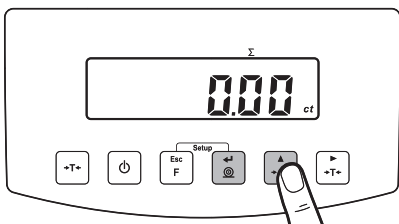

Using key select weighing unit and press key to confirm.

5

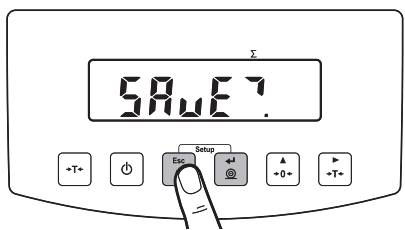

Using key select "SAVE?" value and press key to confirm settings.

The balance enables selecting the following weighing units:

- g (gram)
- ct (carat)
- lb (pound)*

**(lb) pound unit unavailable for verified balances.*

9. PERIPHERAL DEVICE CONNECTORS

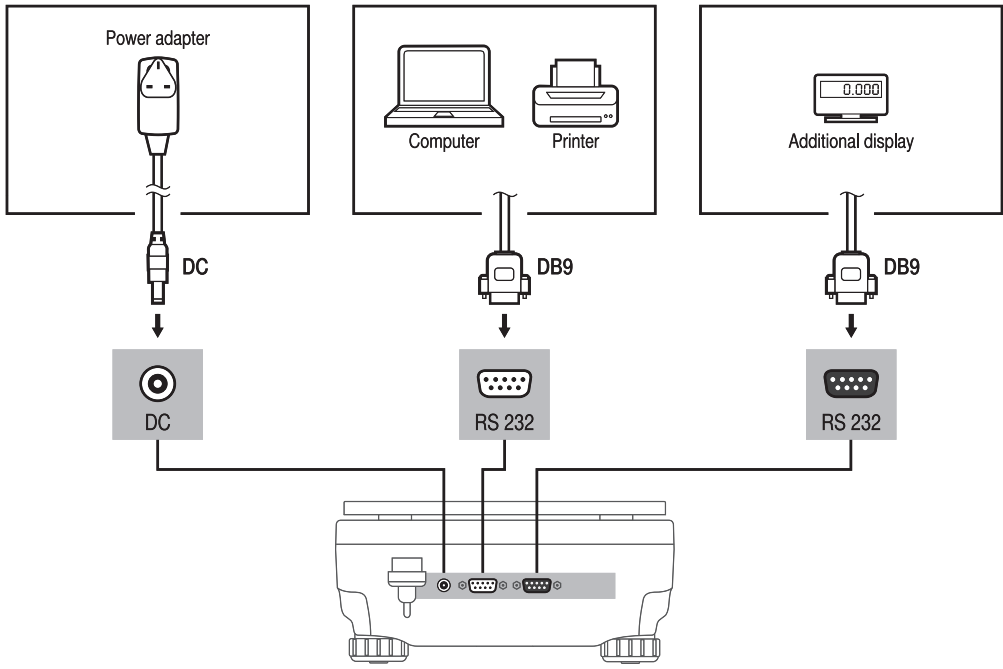

10. DEVICE CLEANING

10.1. General Recommendations

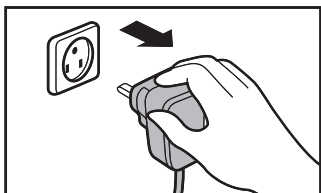

Prior to cleaning, it is necessary to disconnect the balance from the mains.

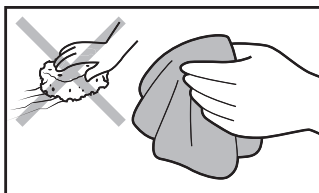

Use soft cloths made of microfiber, natural fiber or man-made fiber. Avoid using abrasive cloths or cloths that might scratch the surface.

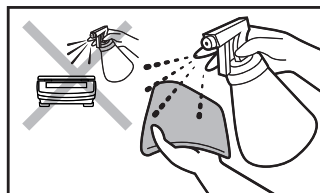

Apply the cleanser onto the cloth first. Avoid applying the cleanser directly onto the device.



Avoid using cleansers containing chlorine, corrosive chemicals and bleach. Do not use cleansers containing abrasive substances or scouring preparations.

10.2. Plastic components

Prior to cleaning the plastic housing, it is necessary to disassemble weighing pan components (cover, weighing pan, etc.).

Clean plastic components using a solution of water and detergent (liquid soap, dish-washing detergent, glass cleaner, etc.).

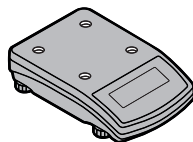

10.3. Stainless steel components

Prior to cleaning the stainless steel components, it is necessary to disassemble them first.

Clean stainless steel components using a solution of water and detergent (liquid soap, dish-washing detergent, glass cleaner, etc.). In case of heavy contamination, a mild solution of vinegar or baking soda can be used.

