

High Performance ECO Pharmaceutical Refrigerator

+2°C to +14°C

12.2 cu.ft. | 345 L



MPR-S300H-PA | 76383-298



The MPR-S300H-PA | 76383-298 medical refrigerator is designed to meet CDC requirements for vaccine and biologics storage. The sliding door configuration, affording easy access while maintaining stable internal temperatures throughout the chamber, is suitable for clinics, hospitals, distribution centers, or pharmacies where frequent access is required.

Easy Access

Argon insulated dual-pane sliding glass doors provide greater access to contents without the external clearance needed by conventional hinged doors. A sliding door greatly reduces air transfer during opening, reducing energy use and maintaining stable internal temperatures throughout the cabinet. An integrated keyed lock provides added security.



Data Archiving

Onboard data logs monitor and record minimum and maximum temperatures over 12- and 24-hour periods supporting CDC clinical recording recommendations. Temperature, alarm, door opening and closing data are retained for 3 months and are accessible for download via USB to ensure daily logs are complete.

Environmental Friendly SNAP Compliance

Clean, natural hydrocarbon [HC] refrigerants used in the MPR-S300H-PA | 76383-298 provide efficient cooling with low global warming potential (GWP) and zero ozone depletion potential (ODP). The combination of HC refrigerants with inverter compressor technology delivers low energy consumption of 1.35 kWh/day based on factory testing.



Temperature Uniformity

Cool air distribution from the top third, bottom and cabinet front maintain temperature uniformity throughout the refrigerator even at full load capacity. Shelves and drawers include designed air gaps for even circulation to maintain temperature uniformity, drive fast recovery upon access and reduced condensation on the door glass for increased visibility. Detailed temperature mapping is available upon request.

Energy Saving Inverter Compressor Algorithm

The PHCbi proprietary inverter compressor algorithm [ICA] modulates the compressor motor speed according to temperature need. Unlike standard on/off compressors, the ICA uses less energy following door openings with faster recovery times. This provides stable uniform temperature during long-term storage; and extended compressor life with less wear-and-tear than conventional compressor refrigerators.



Automated Evaporator Coil Defrost

Ice buildup on cooling coils forces the compressor to work harder. While comparable systems use a timed defrost every 8 hours and may require periodic manual coil defrosting, the MPR-S300H-PA | 76383-298 uses integrated sensors that monitor evaporator coil temperature, and automatically remove ice on coils on demand. Temperature is maintained during the defrost cycle. There is no need to power down or empty contents.

High Performance Pharmaceutical Refrigerator

MPR-S300H-PA | 76383-298



Intuitive OLED control panel

The microprocessor controller and OLED display provide convenient, secure user control with a six-digit keypad lock-out and large clear display that is easily read from across a room. Temperatures are displayed in 0.1°C increments, with minimum/maximum displays customizable for 12- or 24-hour periods. Alarm logs with user-defined limits are displayed and archived. LED cabinet light settings for on, off, delay-off, or automatic with door opening.

Model MPR-S300H-PA | 76383-298 shown with optional wire shelves (left), sliding racks (right).

Available Options

Choose from inventory configurations in a combination of wire shelves and sliding racks. A chart recorder installs in the cabinet base. A battery back-up maintains setpoints and visual displays for up to 8 hours. A door blackout panel protects light sensitive contents. See Options.

Temperature Uniformity Data

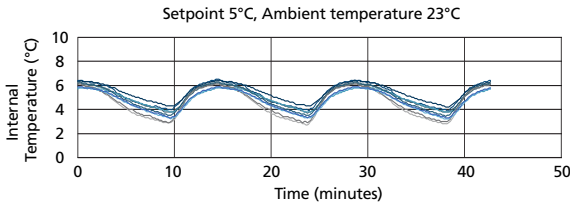

As interior air temperature stabilizes at the desired setpoint, large mass storage volume sustains tight temperature uniformity of the load inside the insulated cabinet.

Dimensions

Unit : inch | mm

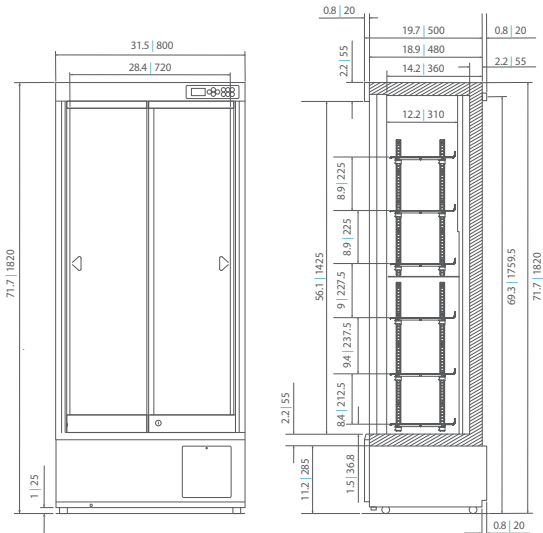

Model Number		MPR-S300H-PA 76383-298
External Dimensions (W x D x H) ¹⁾	inches mm	31.5 x 19.7 x 71.7 800 x 500 x 1820
Internal Dimensions (W x D x H)	inches mm	28.3 x 14.2 x 56.1 720 x 360 x 1425
Volume	cu.ft. liters	12.2 345
Net Weight	lbs kg	229 104
Performance		
Warranty ²⁾		2 years parts and labor, 3 years compressor
Temperature Control Range ³⁾	°C	2 to 14
Control		
Controller		Microprocessor with non-volatile memory
Digital Temperature Display		Digital (white graphic OLED), 1°C (increment of 0.1)
Temperature Sensor		Thermistor
Refrigeration		
Cooling Method		Fan forced air circulation
Defrost Method		Electronically actuated cycle defrost
Refrigerant		SNAP approved (R-600A)
Insulation		CFC/HFC free
Construction		
Exterior Material		Painted steel
Interior Material		Painted steel
Outer Doors	qty	2 (highly insulated double glass door with tempered glass)
Outer Door Lock		Included
Shelves	qty	6 (coated steel wires)
Shelf Dimensions (W x D)	inches mm	27.4 x 10.6 697 x 270
Max. Load - Per Shelf	lbs kg	44 20
Access Port	qty	1
Access Port Position		Rear bottom right
Access Port Diameter	inches mm	1.2 30
Casters	qty	4 (2 fixed, 2 swivel)
Interior Light		LED
Accessories Alarms		
Key	set	x 1
Alarms (V = Visual Alarm, B = Buzzer Alarm, R = Remote Alarm, A = Auto Ring Back, M = Message)		
Power Failure ⁴⁾		R ⁴⁾
High Temperature		V-B-M-A
Low Temperature		V-B-M-A
Door Open		V-B-M
Electrical and Noise Level		
Power Supply		115V / 60Hz
Noise Level ⁵⁾	dB(A)	38
Options		
Circular Type Chart Recorders		MTRC954 97014-882
Chart Paper		C738176 76452-724
Ink Pen	pack of 6	R252 76452-714
Battery Kit For Power Failure Alarm		MPR-48B2-PW 76452-726
Blackout panel with opaque tinting		BPANEL300
Shelves & Sliding Racks		MPR-31RR-PW 76452-728 (for lower right side) MPR-31LRR-PW 76452-730 (for lower left side)
Optional Communication System		
Wireless, Cloud-Based, Automatic Data Management		LabAlert® Monitoring System
Self Powered Output Module		MTR-420-MAC
Quality Management System		
Certification		QPS Listed

¹⁾ Exterior dimensions of main cabinet only, excluding external projections. See dimensions drawings on website for full details.

²⁾ Current warranty offered at time of printing and may be subject to change; US and Canada only.

³⁾ Air temperature measured at refrigeration compartment center and freezer compartment center, ambient temperature +35°C, no load.

⁴⁾ Remote alarm includes optional power failure alarm MPR-48B2-PW | 76452-726 (B-R alarm).

⁵⁾ Nominal value - background noise 20 dB(A).

Specifications are subject to change without notice.

Performance data herein is based on independent testing at time of publication.

Prices, product, and/or services details are current when published and subject to change without notice. | Certain products or services may be limited by federal, state, provincial, or local regulations. | VWR, part of Avantor, makes no claims or warranties concerning sustainable/green products. Any claims concerning sustainable/green products are the sole claims of the manufacturer and not those of VWR International, LLC and/or Avantor, Inc. or affiliates. All prices are in US dollars unless otherwise noted. Offers valid in US and Canada unless otherwise noted, void where prohibited by law or company policy, while supplies last. | Trademarks are owned by Avantor, Inc. or its affiliates, unless otherwise noted. | Visit vwr.com to view our privacy policy, trademark owners, and additional disclaimers. © 2021 Avantor, Inc. All rights reserved.

VWR, part of Avantor is an authorized distributor for PHC Corporation of North America.

PHC Corporation of North America
Printed in USA | 08 | 11 | 2021 | OW12241.2 | vf