



Technical Data Sheet

VWR Cuft Chromatography Refrigerator

Revision-1

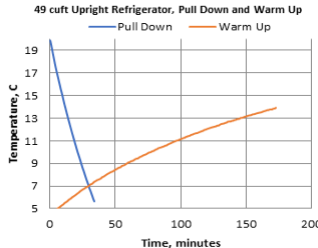
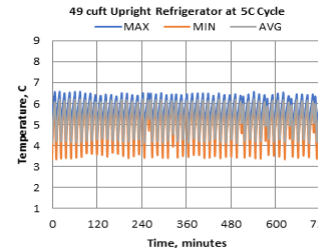

Specifications	Catalog Number																						
	VWG49CSGA																						
	Production Model Number																						
	VWG49CSGA																						
Application, Rating and Electrical Data																							
Application	Chromatography Refrigerator, Semi-Critical Sample Storage																						
Storage Volume	49 Cuft / 1387 Liters																						
Temperature Rating/Set Point	2°C to 10°C / 5°C																						
Electrical Power	115 V / 60 Hz, 1 Phase																						
Instrument Rated Current	5A(Unit) / 4A(Internal Outlet)																						
Building Supply Rating	Breaker 15 Amps/115v± 10%Volt While Operating																						
Power Plug/Power Cord Length	(2X) Three prong NEMA 5-15P, 1.828 Meters (6 Feet)/3.048 Meters (10 Feet)																						
Agency Listings	cULus, Prop 65, Energy Star																						
Sound Pressure Level	47.4 dBA																						
Indoor/Outdoor Usage	Indoor Use Only																						
Application Environment	Non-Corrosive, Non-Flammable, Non-Explosive, Good Air Ventilation																						
Ambient Operating Temperature	15° C - 32° C (60° F - 90° F)																						
Refrigeration Configuration																							
Refrigeration System	Vapor Compression System																						
Compressor / Number	Single speed Hermetic Compressor/1																						
Condenser Type/Number	Finned Tube and Forced Convection Cooled/1																						
Expansion Device	Capillary Tube																						
Evaporator Type	Forced Air Evaporator Coil																						
Defrost Method	Adaptive Defrost																						
Refrigerant Charge/Flammability	85 Grams / Flammable, R290																						
Controller/Electrical System Configuration And Features																							
Controller Type	Digital Controller																						
Controller Level	Eye Level																						
Key Switch	Yes																						
Compressor Safe Guard	Overload Protector																						
Control Sensor	NTC Probe																						
Remote Alarm Terminals	Yes																						
Power Failure Alarm	Yes																						
Dimensions And Construction																							
Interior Dimensions (H x W x D)	61.75 x 49 x 28.5 in. (1569 x 1245 x 724mm)																						
Exterior Dimensions (H x W x D)	81 x 52.7 x 32 in. (2057 x 1339 x 813mm)																						
Insulation	Polyurethane foam with R134a blowing agent																						
Door Perimeter heater	Not Present																						
Shelves / Capacity	(8) Adjustable Wire and (2) Half Shelves. Max. Cap. per Shelf: 45 kg (100 lbs.)																						
All-Direction Casters	4 levelling Feet																						
Ship Weight	Approximately 271kg (597lbs.)																						
Access Port / Dia	Yes / 1 Inch																						
Typical Performance Characteristics																							
<div><div><p>49 cuft Upright Refrigerator, Pull Down and Warm Up</p></div><div><p>49 cuft Upright Refrigerator at 5C Cycle</p></div><div><p>Test Unit Series Number or MSO Number: 19733-A-8-9</p><table><tr><td>Cabinet Load:</td><td>Unloaded</td></tr><tr><td>Average Cabinet Temp at 5C Cycle (C):</td><td>5.3</td></tr><tr><td>Stability (C):</td><td>2.3</td></tr><tr><td>1-min Door Opening Recovery to 5C (min):</td><td>5</td></tr><tr><td>Duty Cycle at 5C (%):</td><td>40</td></tr><tr><td>Cycle (on/off) rate at 5C (min):</td><td>4 / 6</td></tr><tr><td>Energy Consumption (kW-hr/day):</td><td>2.8</td></tr><tr><td>Heat Rejection Rate (btu/hr):</td><td>395</td></tr><tr><td>Pull Down Time (to 5C) (min):</td><td>34</td></tr><tr><td>Warm Up Time (5C to 15C) (min):</td><td>173</td></tr><tr><td>Sound (dBA):</td><td>47.4</td></tr></table></div></div>		Cabinet Load:	Unloaded	Average Cabinet Temp at 5C Cycle (C):	5.3	Stability (C):	2.3	1-min Door Opening Recovery to 5C (min):	5	Duty Cycle at 5C (%):	40	Cycle (on/off) rate at 5C (min):	4 / 6	Energy Consumption (kW-hr/day):	2.8	Heat Rejection Rate (btu/hr):	395	Pull Down Time (to 5C) (min):	34	Warm Up Time (5C to 15C) (min):	173	Sound (dBA):	47.4
Cabinet Load:	Unloaded																						
Average Cabinet Temp at 5C Cycle (C):	5.3																						
Stability (C):	2.3																						
1-min Door Opening Recovery to 5C (min):	5																						
Duty Cycle at 5C (%):	40																						
Cycle (on/off) rate at 5C (min):	4 / 6																						
Energy Consumption (kW-hr/day):	2.8																						
Heat Rejection Rate (btu/hr):	395																						
Pull Down Time (to 5C) (min):	34																						
Warm Up Time (5C to 15C) (min):	173																						
Sound (dBA):	47.4																						
<p>1) Performance is nominal and individual units may vary.</p> <p>2) Refrigerator performance will differ due to product amount, product size and operating conditions.</p> <p>3) Continuous product enhancements may, without notice, result in amendments or omissions to this specification. Thermo Scientific cannot accept responsibility for damage, injury, loss or expenses resulting from misapplication of the information herein.</p>																							



Typical Cabinet Temperature Map
Refrigerator 49cuft, 8 Inner-Shelves, 2 Outer Doors

Temperatures are averages during > 20
cycles after reaching a setpoint of 5C

Top View of Shelves

REAR	M3	M4	M53	M54
	M5		M55	
FRONT	M1	M2	M51	M52
	M8	M10	M58	M60
		M7		M57
	M14	M15	M64	M65
	M11		M61	
	M18	M19	M68	M69
	M20		M70	
	M16	M17	M66	M67

	M1	M2	M3	M4	M5	M7
Avg	5.3	5.4	5.1	5.3	5.3	5.2
Max	6.2	6.3	6.1	6.2	6.2	6.1
Min	4.1	4.2	3.5	3.9	4	3.8

	M8	M10	M11	M14	M15
Avg	5.2	5	5.1	5	5.2
Max	6.2	6.2	6.1	6.1	6.2
Min	3.6	3.1	3.6	3.2	3.7

	M16	M17	M18	M19	M20
Avg	5.2	5.4	5.1	5.6	5.1
Max	6.2	6.2	6.2	6.4	6.3
Min	3.7	4	3.2	4.4	3.4

	M51	M52	M53	M54	M55	M57
Avg	5.4	5.2	5.4	5.2	5.3	5.4
Max	6.2	6.2	6.2	6.2	6.2	6.2
Min	4.3	3.6	4.4	3.9	4.2	4.5

	M58	M60	M61	M64	M65
Avg	5.4	5.2	5.2	5.2	5.3
Max	6.2	6.1	6.1	6.3	6.2
Min	4.4	3.9	3.8	3.4	4.3

	M66	M67	M68	M69	M70
Avg	5.5	5.7	5.4	5.6	5.3
Max	6.3	6.6	6.2	6.3	6.3
Min	4.4	4.7	4.1	4.6	4

Front View

19733-A-8-9

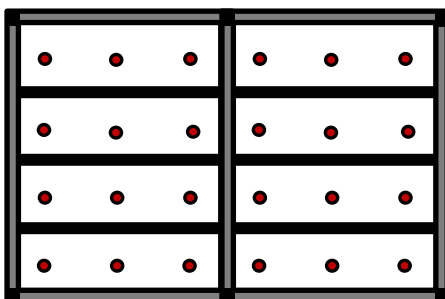

Cabinet Average: 5.3 C
Probe Average: 5.5 C

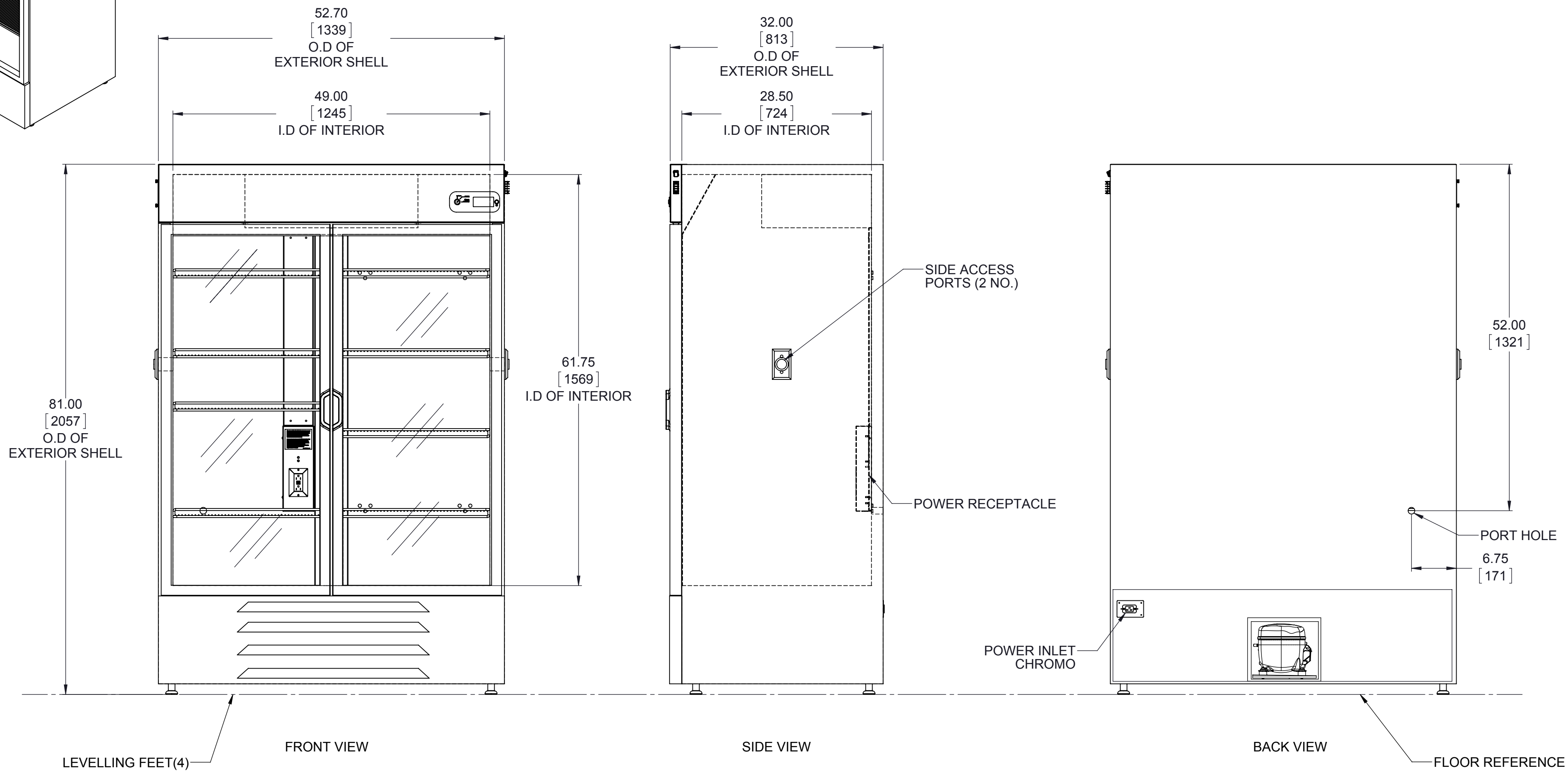
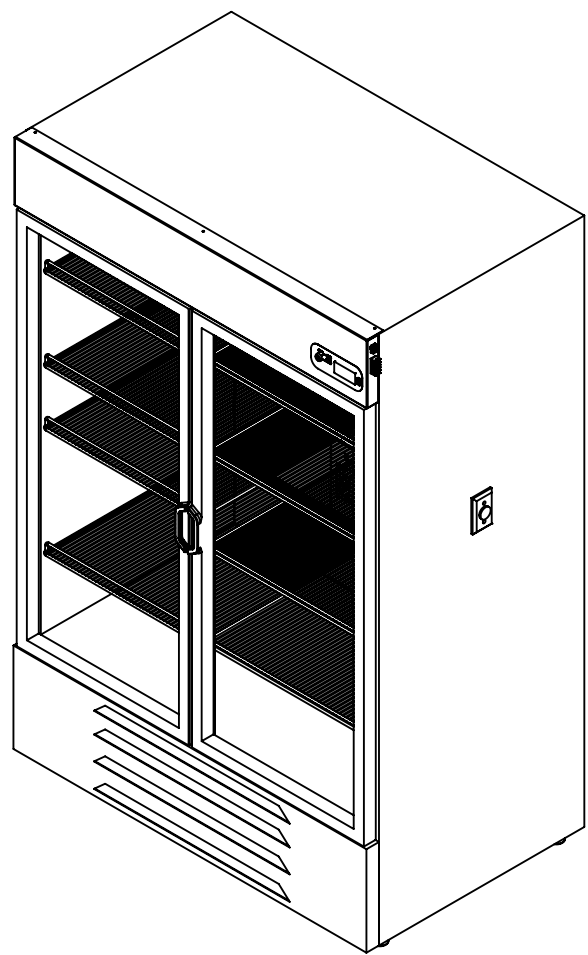

NOTE: DUAL DIMENSION IS INCHES OVER MILLIMETERS
DO NOT USE FOR ENGINEERING PURPOSES. SUBJECT TO CHANGE WITHOUT NOTICE.

49cu.ft.
8 Full Shelves & 2 Half Shelves
Double Door Chromatography
Top Mount Controls