

3 ft<sup>3</sup> Chest ULT, 115V/60Hz, Pull Down and Warm Up at 23 C

3 ft<sup>3</sup> Chest ULT, 115V/60Hz -80C Cycle at 23 C Ambient

Test Unit Series Number or MSO Number:	18821-C-A
Cabinet Load	Empty
Average Cabinet Temp at -80 C Cycle (C):	-77.8
Average Uniformity (C):	2.1
Average Stability (C):	5.1
Peak Variation (C):	7.1
Cycle (on/off) rate (minutes):	11 / 19
Duty Cycle (%):	36.8%
Avg. energy consumption (kW-hr/day):	5.5
Avg. heat rejection rate (Btu/hr):	779
Pulldown Time (-50 to -80 C) (minutes):	38
Warmup Time (-80 to -50 C) (minutes):	166

- 1) Performance is nominal and individual units may vary.
- 2) Freezer performance will differ due to product amount, product size and operating conditions.
- 3) Continuous product enhancements may, without notice, result in amendments or omissions to this specification. VWR International, LLC cannot accept responsibility for damage, injury, loss or expenses resulting from misapplication of the information herein.

\* Manufacturer measured compressor capacity taken at standard -23°C/49°C (Evap/Cond) condition.

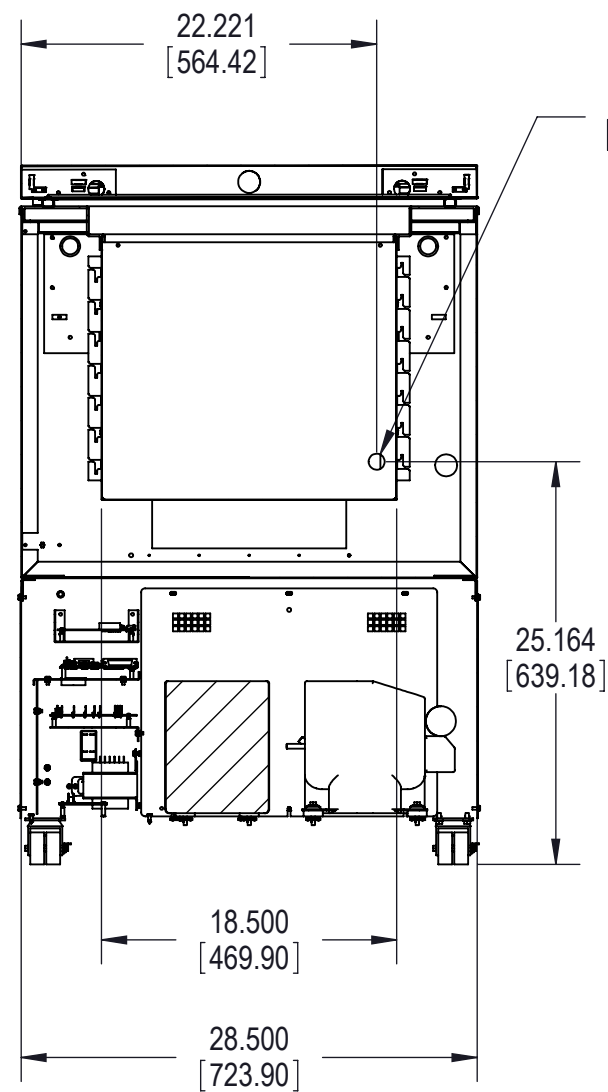

SECTION A-A

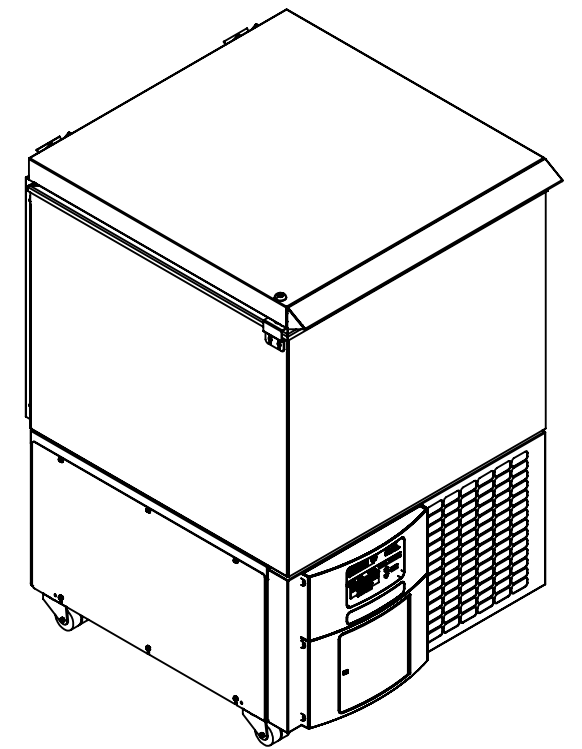
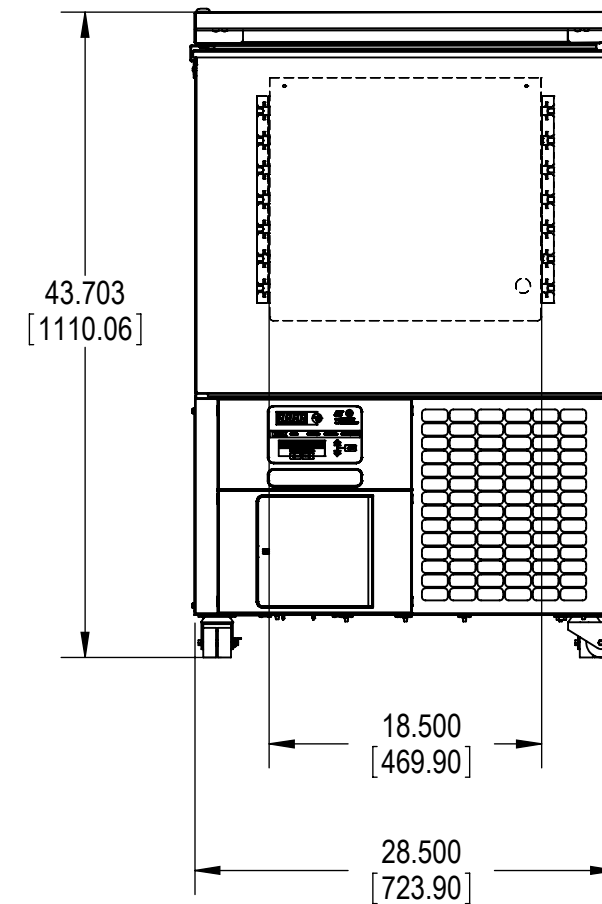
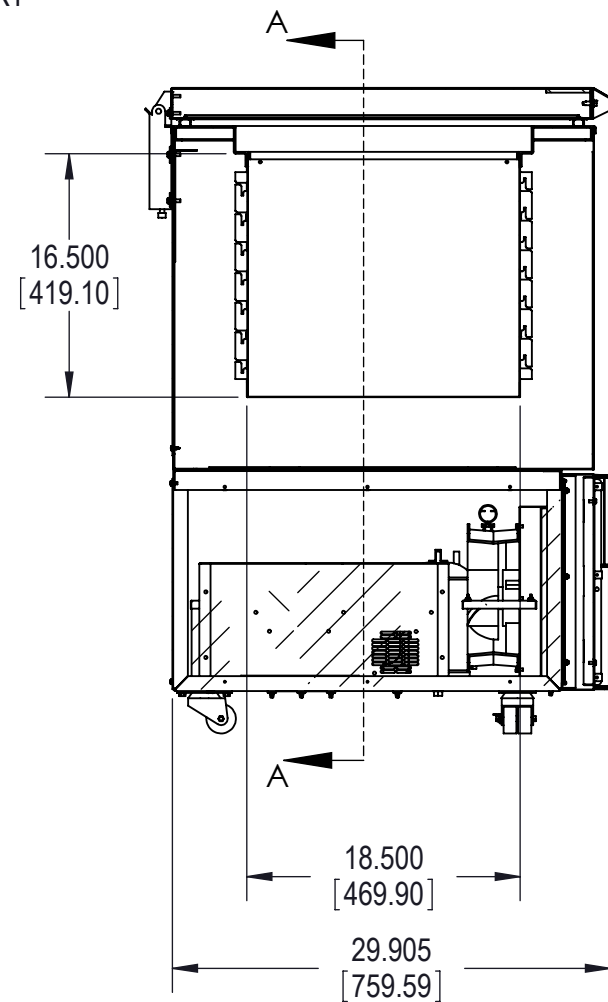

NOTE: DUAL DIMENSION IS INCH OVER METRIC

DO NOT USE FOR ENGINEERING PURPOSES SUBJECT TO CHANGE WITHOUT NOTICE