



Lab equipment

Exceptional environmental control

Heratherm Stability Chambers



Thermo Scientific™ Heratherm™ Stability Chamber, Cat. No. **77486-610**

Applications

- Stability testing
- Shelf-life testing
- Environmental testing
- Other quality control environments

Benefits

- Sustainable features
- Meets requirements for ICH Q1A (R2) and enables 21 CFR Part 11
- Programmable for restricted access
- Easy to program and operate
- Easy to maintain and move
- Extensive alert and alarm functions
- Choice of exterior solid door with interior glass door or exterior glass door
- 24-month warranty

The Heratherm Stability Chamber is an exceptional choice for use in quality control laboratories where stability or shelf-life testing is required. The chamber meets ICH stability testing guidelines according to ICH Q1A (R2).

A broad relative humidity range covers many application needs including humidity levels below ambient. Peltier technology supports temperature stability while offering lower energy usage, compared to traditional compressors.

The humidification system with an integrated water tank has a low water consumption with no need for a drain. Very accurate relative humidity levels help provide process reliability and the heated door minimizes potential condensate in standard applications.

Achieve data traceability and sample protection when using the restricted access functions found through the touchscreen user interface. Data logging enables 21 CFR Part 11, and IQ/OQ qualification can be implemented with a service package.

The internal chamber has rounded corners, removable shelves, and other components to help facilitate easy maintenance.

Heratherm Stability Chambers

Product specifications

Specification	Description
Models	
Solid door with inner glass door	77486-610
Exterior glass door	77486-608
Overview	
Chamber size	750 L / 26.5 cu. ft.
Controller	Microprocessor, PID: temperature, relative humidity (RH), with programmability
User interface	7 in. display with capacitive touchscreen
Temperature	
Temperature range	0 to 70°C / 15 to 40°C with optional sockets
Temperature range with humidity	0 to 70°C (see Figure 1)
Temperature increments	0.1°C
Peltier cooling / heating capacity	$\Delta T \geq 25^\circ\text{C}$ / $\Delta T \geq 52^\circ\text{C}$
Temp. uniformity at 20 to 37°C	$\leq \pm 0.1^\circ\text{C}$
Temp. stability at 20 to 37°C	$\leq \pm 0.1^\circ\text{C}$
Heat up time to 37°C	≤ 50 min.
Heat up time to 60°C	≤ 110 min.
Cool down time to 0°C	≤ 200 min.
Recovery time at 37°C	≤ 7 min.
Humidity	
Humidity range at 37°C	10 to 90% RH (see Figure 1)
Humidity increments	0.1°C
Humidity stability	$\leq \pm 2\%$
Water consumption	0.15 to 1 L per day*
Water specification	Demineralized water, resistance = 0.05 to 1 M Ω
Water supply	Water reservoir 5 L
Electrical	
Voltage, power	100 to 240 V, 50/60 Hz, 1400 W
Energy consumption	5 to 15 kWh per day*
Power plug	Standard plug, based on country: US, EU (Schuko), UK, CN, IN, AU, CH, JP**, DK**
Power cord length	2 m power cord
Shelving / load	
Shelves (std. / positions)	3 / 36
Shelf construction	Perforated stainless steel, Type 1.4301 / AISI 304
Shelf dimensions (W x D)	795 x 575 mm / 31.3 x 22.6 in.
Shelf surface area	0.46 m ² / 4.9 ft ²
Max. load on shelf	15.9 kg / 35 lbs. (pulled out) / 30 kg / 66.1 lbs. (stationary)
Max. load on reinforced shelf	90 kg / 198.4 lbs. (stationary)
Max. total load	210 kg / 463 lbs.
Dimensions	
Internal dimensions (W x H x D)	840 x 1450 x 630 mm / 33.07 x 57.09 x 24.8 in.
Exterior dimensions (W x H x D)	1080 x 1835 x 885 mm / 42.52 x 72.24 x 34.84 in.
Shipping weight	ESS750: 381 kg / 840 lbs. ESG750: 372 kg / 820 lbs.
Installation space requirements	Back wall: 200 mm / 7.9 in. Side wall: 150 mm / 5.9 in. Ceiling: 570 mm / 22.5 in.
General information	
Connectivity	Back: Ethernet, USB, dry contact; Front: USB
Access port (standard)	2, right and left side
Calibration certificate included	30°C / 60% RH
Certifications	UL, CE

Note: All values are measured according to DIN12880

* Value depends on settings, usage, and environmental conditions

** Cord length of 2.5 m / 8.2 ft.

Stability chamber with temperature & RH control

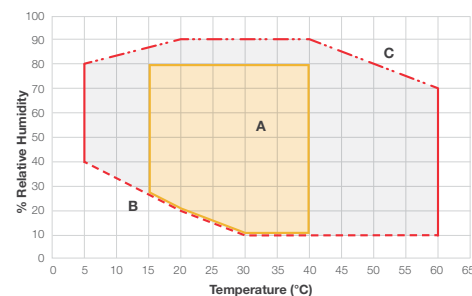

Figure 1.

Relative humidity—temperature

(Reference ambient condition: 22°C; <50% rel. humidity).

Area A

Effective temperature and humidity range (condensate-free area).

Area B

Very low temperature and humidity area. Reachable only if the ambient condition is significantly lower and the chamber samples are very dry.

Area C

Immediate condensation formation area at coldest point of unit.

- Maximum humidity, LED light off (Condensate-free boundary line)
- Minimum humidity, LED light off
- Limited range factory-installed electrical socket options
When electrical sockets are installed, temperature and relative humidity levels are limited

Front view

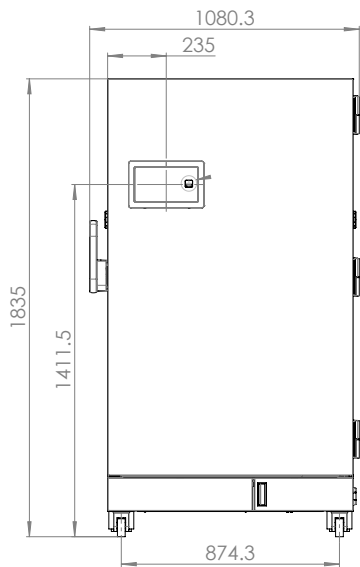

Front view with ext. solid door

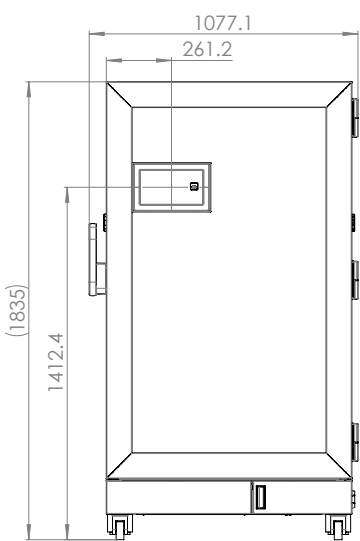

Front view with ext. glass door

Side view

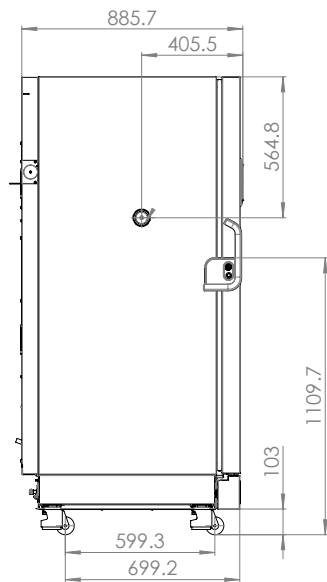

Note: Measurements in mm.

Side view, interior

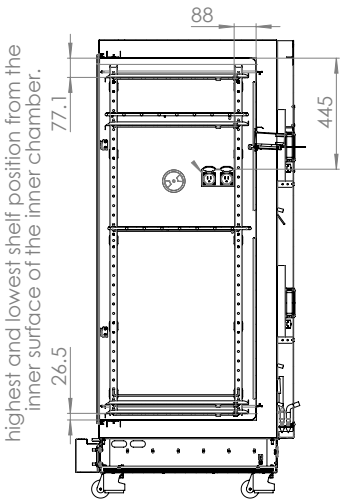

Top view

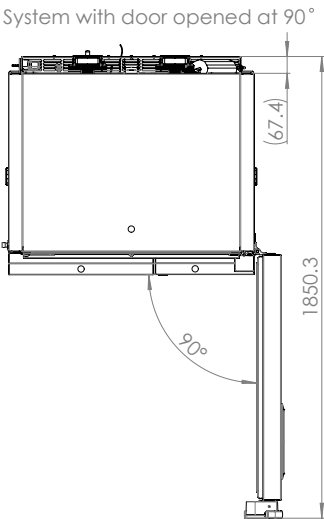

Visit us.VWR.com to learn more.

For Laboratory Use. It is the customer's responsibility to ensure that the performance of the product is suitable for customers' specific uses or applications.



delivered by **VWR**tm

VWR.COM

Prices, product, and/or services details are current when published and subject to change without notice. | Certain products or services may be limited by federal, state, provincial, or local regulations. | VWR, part of Avantor, makes no claims or warranties concerning sustainable/green products. Any claims concerning sustainable/green products are the sole claims of the manufacturer and not those of VWR International, LLC and/or Avantor, Inc. or affiliates. All prices are in US dollars unless otherwise noted, void where prohibited by law or company policy, while supplies last. | Trademarks are owned by Avantor, Inc. or its affiliates, unless otherwise noted. | Visit vwr.com to view our privacy policy, trademark owners, and additional disclaimers. © 2024 Avantor, Inc. All rights reserved.